

CROESO CYNNES I BAWB

ST CLEARS YFC AGRICULTURAL SHOW 2017

(Established in 1878)

**President 2017—Mr Edward & Mrs Paula Thomas
Trefenty Farm, St. Clears**

**THE UNITED COUNTIES SHOWGROUND
CARMARTHEN. SA33 5DR
(A40 Carmarthen – St. Clears dual carriageway)**

SATURDAY, 20th MAY, 2017

Classes for HORSES

WPCS BRONZE MEDAL SHOW* – Entries close 10th MAY 2017
2017 NATIONAL WELSH CHAMPIONSHIP QUALIFIER*
BSPS QUALIFIER* TSR QUALIFIER*

CATTLE, DAIRY, BEEF

New for 2017 SOUTH WALES JERSEYS DE CYMRU

SHEEP, DOGS, HORTICULTURE & VINTAGE

No Telephone Entries received after 9.00pm
Entries accepted on the day for all other classes
at an additional cost of £2.50 per entry
but would be appreciated beforehand

Pre entries would be greatly appreciated with correct money.

**General Secretary—ALISON EBSWORTH, Dolifor,
Bethlehem Road, Pwll Trap, St. Clears. SA33 4AN**

Tel: 01994 230869/07870 390734

email: Aebsworth@aol.com

www.stclearsyfcshow.co.uk

HOLDING NO.: CPH 550208613

ST. CLEARS YFC AGRICULTURAL SHOW SATURDAY, 20th MAY, 2017

Sponsorship Packages

**please contact Robert Thomas (NFU) -
01994 230898**

Advertising Banner will be charged at **£40.00**

Show Day Catalogue

½ Page Black & White **£40.00**

Full Page Black & White **£75.00**

Full Page Colour on Cover **£100.00**

Class Sponsorship (Sponsor's Badge)

Group Sponsorship (Name in catalogue) **£100.00**

Single Class (Name in catalogue) **£20.00**

Championship Section Sash **£25.00**

MEMBERSHIP 2017 £5.00 per person

*(Please let Sponsorship Secretary know
before 1st May 2017)*

General Sponsorship **£50.00 or over**
(Name in Catalogue, Car Pass and Parking)

TRADE STAND SECRETARY 2017

Miss Alys Williams, Cornel Ni,

Pwll Trap, St. Clears.

Tel: 01994 230576

Email: alyswilliams94@btinternet.com

ST. CLEARS YFC AGRICULTURAL SHOW 2017

President Elect: . . Mr Edward & Mrs Paula Thomas, Trefenty Farm, St. Clears

Chairman: Mr Mark Davies, Troed Y Rhiw Farm, St. Clears Tel: 01994 230377

Vice Chairman: Mrs Sarah Phillips, Brynteg, Llangynog, Carmarthen
Tel: 01267 211217

General Secretary: Ms Alison Ebsworth, Dolifor, Bethlehem Road,
Pwll Trap, St. Clears Tel: 07870 390734 or 01994 230869
Email: Aebsworth@aol.com

Horticultural Secretary: To be confirmed

Treasurer: Mr David Parry Williams, Coedfryn, Penybont, Trelech

Sponsorship Secretary: T.B.C.

Dog Show Secretary: T.B.C.

Trade Stand Secretary: Miss Alys Williams, Cornel Ni, Pwll Trap,
St. Clears Tel: 01994 230576
Email: alyswilliams94@btinternet.com

Honorary Veterinary Surgeons: . . Market Hall Veterinary Group, St. Clears
www.markethallvets.co.uk

HORTICULTURAL HALL

CLASSES FOR COOKERY, CRAFTWORK, FLORAL ART,
PRODUCE, JUNIOR & SENIOR COMPETITIONS

GENERAL COMMITTEE 2017-2018

Mrs Elizabeth Davies
Miss Alison Ebsworth
Mrs Carolin Gibbs
Mr Kevin Jones
Mr Phillip Morgan MRCVS
Mr David Parry Williams
Mrs Sarah Phillips
Mrs Lynne Thomas
Mr Windsor Thomas
Mr Jonathan Williams
Mr Adrian Windsor

Mr Mark Davies
Mrs Elizabeth Evans
Mrs Sally Hancock
Mr S W R Michell MRCVS
Mr Julian Mousley
Mr Rhys Phillips
Mr Elfan Thomas
Mr Robert Thomas
Mr Elfan Williams
Miss Alys Williams
Mr Dewi Thomas

ALL PRIZE MONEY WILL BE PAID ON THE DAY

www.stclearsyfcshow.co.uk

ST. CLEARS YFC AGRICULTURAL SHOW – PAST PRESIDENTS

2016	Mrs Elizabeth Davies, Penycoed Farm, Llangynin, St. Clears	1995	<i>The Late</i> Mr Keith Lewis, Picton House; Llanddowror
2015	Mr Wyndham Phillips, County Stores Bakery, St. Clears	1994	<i>The Late</i> Mrs Nansi James, Cartrefni, Meidrim
2014	Mr Eifion Howells, Maescowin, Bancyfelin, Carmarthen	1993	<i>The Late</i> Mr Gwynfor Husband, Penparc, St. Clears
2013	Mr Trevor Phillips, Parc Y Abbot Farm, St. Clears	1992	<i>The Late</i> Mr Billy Rees, Cethin, St. Clears
2012	Mr S.W. R. Michell, M.R.C.V.S., St. Clears	1991	Mr Gerwyn Griffiths, Blaencorse, St. Clears
2011	Mr Julian Mousley, St. Clears	1990	<i>The Late</i> Mr George Hancock, Pwlyllygravel, St. Clears
2010	Mr Gilbert Williams, St. Clears	1989	<i>The Late</i> Mr Mansel Davies, Plasygwer, St. Clears
2009	Mr Phillip Morgan, M.R.C.V.S., St. Clears	1987	<i>The Late</i> Mr Hugh Evans, Clogyfran, St. Clears
2008	Mr David Phillips, Caertrafle, St. Clears	1986	Mr Clive Reece, Rosebrook, St. Clears
2007	Mrs Mary Davies, Whitland	1985	<i>The Late</i> Mr Gwyn Davies, High St, St. Clears
2006	Mr D. P. Williams, J.P., St. Clears	1984	<i>The Late</i> Mr Elis Griffiths, Llwynpiod, St. Clears
2005	Alun Davies, M.R.C.V.S., and <i>The Late</i> Hugh Davies, M.R.C.V.S., St. Clears	1983	Mr D P Phillips, Plasnewydd, St. Clears
2004	Mr Phillip Hughes, St. Clears	1982	<i>The Late</i> Mr D W Picton Davies, Asgoed, St. Clears
2001/03	Mr Lynn Jones, Talfan, St. Clears	1981	Mr David King Thomas, St. Clears
2000	Mr Eric Davies, Ty-Newydd, St. Clears		
1998/99	<i>The Late</i> Mr Bryant Rees, Avola, Red Roses		
1997	Mr Huw Phillips, Gilfach, Llanboidy		
1996	<i>The Late</i> Mr W. P Evans, Green Gables, St. Clears		

GATE CHARGES 2017

ADULTS £6.00 CHILDREN & OAP £3.00

**ALL LORRIES CONVEYING LIVESTOCK/HORSES AND EXHIBITORS
ARE TO BE ADMITTED TO THE SHOWGROUND FREE OF CHARGE**

ALL OTHER VEHICLES AND PERSONS MUST PAY

**DOG SHOW & HORTICULTURAL EXHIBITORS WILL ALSO
HAVE TO PAY FULL ADMISSION INTO THE SHOW**

**DOG SHOW EXHIBITORS WILL RECEIVE ONE FREE
COMPLIMENTARY TICKET FOR EACH ENTRY**

Your Co-operation is greatly appreciated

www.stclearsyfcshow.co.uk

GENERAL INFORMATION

Directions –

From the East : As you enter Carmarthen on the A48 to Pensarn Roundabout, follow the signs for the A40 St Clears. The Showground is approx 1 mile west of Carmarthen on the dual carriageway on the left hand side. Follow brown showground signs.

From the North : Travel on the A40 into Carmarthen and follow signs to St Clears as above.

From the West: Travel to St Clears on the A40 from Haverfordwest (or A477 from Tenby & Pembroke) and follow Showground signs on dual carriageway just before you reach Carmarthen.

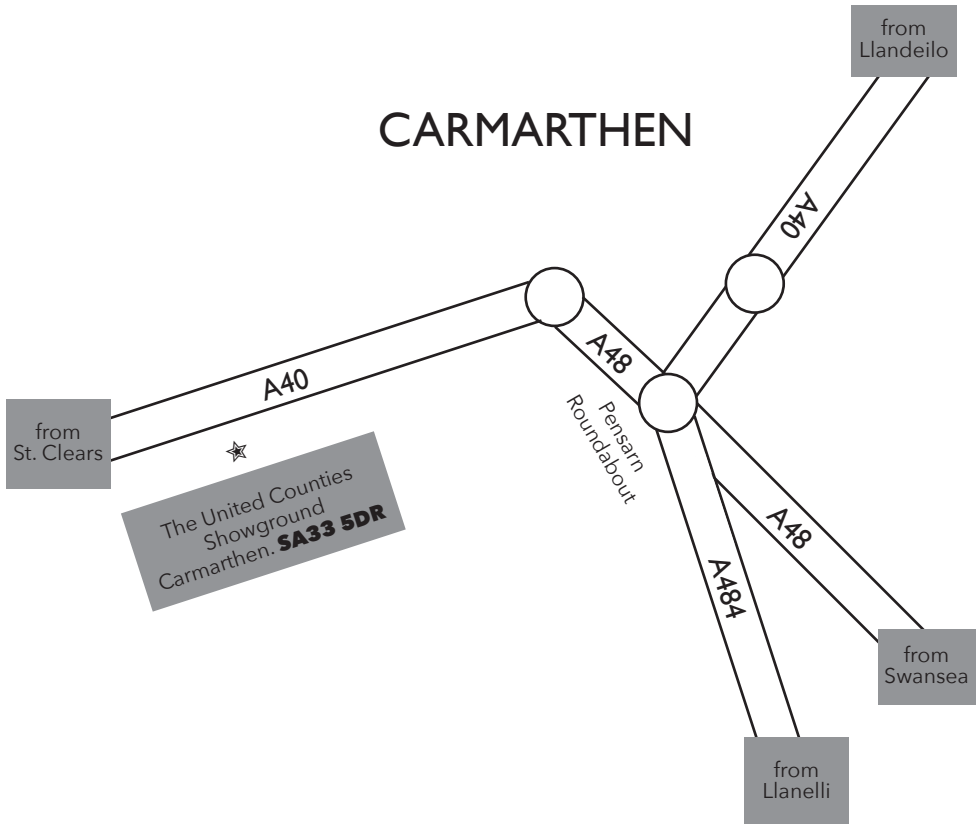

Opening Times

The show is open from 7.00am until 6.00pm.

Catalogues and Programmes

These are available from Gate Stewards and Section Secretaries on show day.

Secretaries Office on Show Day -

The main show office will be located under the grandstand at the showground.

First Aid

St. Johns Ambulance will be in attendance for medical cover for the duration of the show. Their main base will be located next to the main secretary's office. **ALL EXHIBITORS WILL INCUR A £1.50 FIRST AID COVER CHARGE TO THEIR ENTRY FORM**

Toilets

Toilets are located on the showground to the rear of the main grandstand.

Car Parking

Public car parking is free. Service buses run from Carmarthen Town to the outskirts of the showground (Mart Entrance) on a regular basis. The Show Committee is not liable for any damage or theft to any vehicles parked on the showground. Owners park at their own risk.

Catering Facilities

Mobile catering services are available on the showground throughout the day. Catering is also available in the main Judges & Stewards area, situated just under the main Grandstand.

Lost Property

A Lost Property box is held in the main Show Office.

Veterinary Services

Market Hall Vets, St. Clears are on site for the duration of the show for livestock and equine emergencies.

Farrier

Please check with the main secretary for contact details of Farrier on show day.

Dogs

Dogs are welcome at the show provided they are kept on the lead **AT ALL TIMES**. Please pick up and dispose of any mess left by your dog.

Police

Dyfed Powys Police will be in attendance on the showground during the day.

Biosecurity

The general public are reminded to wash hands after handling or touching any of the livestock on site to prevent the spread of disease.

Health & Safety Arrangements

The Show Committee would like to kindly remind everyone to be aware of **ALL** livestock, horses and moving vehicles and machinery whilst on the showground, and that all care is taken to prevent any accidents. Exhibitors, Judges and Stewards are to enter any show ring.

Responsibilities for Health and Safety

The Show Committee has overall responsibility for all aspects of Health and Safety and shall require everybody under its control to be familiar with regulations, codes of practice and the Society's procedure for ensuring the safe working conditions on the Society's premises.

The Health and Safety Officer shall be responsible for: (a) Providing guidance and advice on health and safety matters. (b) Liaising with all statutory and external authorities and other appropriate organisations. (c) Investigating and recording all accidents. (d) Briefing and training all officials and stewards on the emergency procedure prior to the show day. (e) Co-ordinating health and safety and the response to emergency and major incidents in the Showground.

Organisers, Trade Stand Personnel, Contractors and their respective employees as well as Estate Owners and their Agents are responsible for ensuring that: (a) Everything reasonably practicable is done to ensure the Health, Safety and Welfare of those attending the show. (b) They conduct themselves and their activities so that they do not put themselves or anyone else at risk. (c) The access to, and egress, from the site is safe and unobstructed. **MEMBERS OF THE PUBLIC AND COMPETITORS** are equally responsible for ensuring that they do not put other persons at risk and that they co-operate with the organisers in complying with Health and Safety legislation.

HEALTH AND SAFETY ARRANGEMENTS 2017

(a) **ELECTRICITY** – the position and routes of overhead, underground and temporary electrical cables and distributions systems will be agreed; evidence of recent examination and test certificates for electrical installations and apparatus will be obtained for show ground installations and from individual exhibitors; earthing and earth leakage protection will be provided as necessary.

(b) **GENERATORS** must be positioned well clear of tentage, straw bales, etc., which can, and do easily catch fire.

(c) **LIQUID PETROLEUM GAS** – Trade Stand personnel and Caterers with LPG appliances should have had these examined and tested by a competent person.

(d) **MACHINERY & EQUIPMENT** – All machinery and equipment should only be operated with adequate safety precautions in place, by competent or supervised people, provided with appropriate personal protective equipment.

(e) **ANIMALS** – Routes used by Horses, Public and Vehicles will, as far as possible, be kept separate. Horses are not allowed into the Trade Stand and Catering areas. Dogs should be kept on leads at all times and children must be supervised by an adult.

(f) **FIRE PRECAUTIONS** – The local Fire Brigade has been consulted concerning Emergency access for Fire Brigade Vehicles and Emergency exits. Adequate Emergency fire fighting equipment and appliances have been provided.

(g) **SAFETY INFORMATION** – Warning notices and signs are prominently displayed. First Aid sites are clearly marked.

(h) **TOILET AND WASHING FACILITIES** – Adequate provision has been made for the expected number of visitors.

(i) **FOOD HYGIENE** – Caterers are responsible for complying with the Local Environment Health Department legislation/Food Safety Act.

(j) **LICENSING FOR ALCOHOLIC REFRESHMENTS** – Licences are held for alcohol sale.

EXHIBITORS' RULES/PUBLIC HEALTH & SAFETY 2017

1. The show to commence at 9.00am prompt, unless due to adverse weather conditions the show committee will have to postpone. **ALL EXHIBITS NEED TO BE ON THE FIELD BY 9.00am PROMPT**
2. The Show Committee have taken all reasonable precautions to ensure the Health and Safety of everyone present.
3. All exhibitors to be considered solely the responsible for their exhibits at all times during the show.
4. All **DOGS** on the Showground must be properly restrained by way of a short lead at all times. All children on the Showground must be properly supervised by an adult at all times.
5. Exhibitors must take all responsible precautions to avoid and prevent accidents occurring.
6. The Show Committee will **not** in any case, or under any circumstances hold itself responsible for any loss, damage, mis-delivery, illness or accident, that may occur through or to any exhibit, trade stand or person from any cause whatsoever, and it shall hold the Show Committee harmless and indemnify it against any legal proceedings arising from any of the above named circumstances.
7. The Show Committee will not be held responsible for any irregularities within the Schedule or Catalogue.
8. In entering any classes in this Schedule/Catalogue, all exhibitors will be deemed by the Committee to have read and be willing to adhere to all Show Ground and Section Rules within.
9. All prize money will be paid out on the production of a Prize Card. Any winnings not collected by the end of the day will be re-banked by the Show, unless the Secretary has been made aware of any mitigating circumstances.
10. **ALL SILVERWARE** may be held for one year by section winners, unless it has been won outright. Winners will have to sign for the trophy/cup and return it to the show in good condition at least **TWO MONTHS** prior to the show in the following year. In signing for receipt the winner will expect to compensate the show for the repair of any damages or replacement of any lost, or unreturned cups by the **1st APRIL 2017**.
11. All exhibitors bringing any type of bedding must remove/dispose of this before leaving the show ground. **CATTLE & SHEEP SECTION PLEASE NOTE**
12. All exhibits must be properly haltered and capable of being led quietly. Unruly animals will be ordered from the show field.
13. Exhibitors must **USE NUMBERED CARDS** so that they can be readily visible to the announcers, and as a reference to spectators. **THESE ARE TO BE COLLECTED FROM SECTION SECRETARY ON SHOW DAY AND WILL NOT BE POSTED.**
14. Classes will be **JUDGED IN THE ORDER THAT THEY APPEAR IN THE CATALOGUE.** Nevertheless if it appears necessary to alter the programme, this will be the Judges/Chief Stewards prerogative. Classes of insufficient numbers may be cancelled/amalgamated at the **JUDGES/CHIEF STEWARDS discretion.**
15. The Show cannot be held responsible for classes clashing. Exhibitors not coming forward on the calling of classes shall forfeit their money. **IT IS UP TO YOU AS EXHIBITORS TO DECIDE WHAT CLASSES YOU ARE TO ENTER.**
16. Exhibits not brought into the ring immediately, when called upon by the Stewards will be disqualified.
17. No exhibit can leave or re-enter the ring after being presented for judging.
18. Exhibits deemed unfit for presentation by the Judge or Veterinary Surgeon will be disqualified.
19. The Judge's decision is **FINAL** with no exceptions. Exhibitors who undermine that decision or any of the **SHOW RULES** will be ordered from the Show Field and all their prize money forfeited. All future entries will be declined.
20. Any objections to the Judging must be forwarded in writing with a fee of £25.00 to the General Secretary within half an hour of the class's competition.

21. Weighting of sheep and measuring of horses will be at the Judge's discretion. Equine exhibits will be asked to produce a valid height certificate for any Horse/Pony called forward for measurement.
22. All entries for the **WELSH PONY AND COB SOCIETY BRONZE MEDAL CLASSES** must either be received prior to show day for cataloguing or on show day at an extra cost of £2.50 per entry. **Entries close 10th May 2017.**
23. Exhibitors are to keep to the allocated areas/collecting rings. Exhibitors who are asked more than once to return to designated area will be asked to leave the Show, and all entry money will be forfeited.
24. All Classes will remain open unless otherwise stated on the schedule.
25. A £1.50 fee is to be paid by each exhibitor for the provision of St. Johns Ambulance service, as detailed on the entry form.
26. Animals pre-entered and substituted on show day will be charged the **FULL** entry fee.
27. **REPORTING OF INJURIES AND DANGEROUS OCCURRENCES (RIDDOR)** Any accident or incident must be reported to the Show Safety Officer immediately. The Safety Officer will investigate all incidents and liaise with the appropriate enforcing authority and show organisation. All accidents will be recorded in the Society's accident book.

STEWARDING

Have you a few hours to spare show week evenings or on the day? We are always welcome to any new members joining the show committee and stewarding on the day. Would you like to learn more of what goes on in a show ring? Cattle, Sheep, Horse and Horticultural Stewards are always welcomed. If you have a spare hour then please let us know. Without you this event could not run. Speak to a member of the show committee for further information.

LIVESTOCK BOXES WILL BE CHECKED AT MAIN GATE

YOUR CO-OPERATION IS GREATLY APPRECIATED

The Show Committee acknowledges the support and loyal assistance of a great many members or voluntary helpers who have given their time prior to and on the show day itself. Without such dedicated people, the Show would most definitely not be able to provide such an event.

We wish to thank the local communities of St. Clears for their continued support and enthusiasm over the years. As an agricultural show, members are only too aware that we must adapt to the ever increasing changes within rural life and as such we have endeavoured again this year to provide a full and varied programme.

***Diolch i chi am eich cefnogaeth hael a mwynhewch eich diwrnod gyda ni.
The Show Committee is always grateful for any form of sponsorship that we receive.***

www.stclearsfcsshow.co.uk

BE SEEN TO BE CLEAN

GWARTHEG / CATTLE SECTION

Holding Number - CPH 550208613

Chief Stewards Cattle Section

Mr Windsor Thomas, Llys Briallu, Llysonnen Road, Carmarthen
 Mr Kevin Jones, Talfan Farm, St. Clears



Show Day Secretaries

Mrs Elizabeth Evans, Lan Farm, Meidrim
 Mrs Sandra Williams, Cornel Ni, Pwll Trap, St. Clears



Cattle Stewards

Lloyd Evans, Linley Griffiths, William Griffiths, Dorman Davies,
 Trevor Phillips, Dai Phillips, Aeron Owens, Geraint Davies, Roger Williams

CATTLE TIMETABLE

**ALL CLASSES TO FOLLOW: EXHIBITORS MUST MAKE SURE
 THAT THEY ARE ON THE SHOWFIELD IN GOOD TIME
 IN CASE OF TIME AND RING AMENDMENTS**

- 10.00am Calf and Calf Handling
 Beef Calf Handling
 Young Handler
 Local Dairy, Best Local Beast
 Holstein U.K., Jersey
 Any Other Dairy, Interbred Dairy Pairs
- 10.00am Dragon JerseyFest 2017 **NEW** Please see Classes for 2017
- 11.00am Hereford,
 Welsh Black, Limousin,
 British Whites, Any Other Beef Commercial Beef
 Beef Pairs Championship
- 2.00pm Supreme Champion Dairy or Beef

SILVERWARE

Please return all Silverware won in 2016 by **1st April, 2017.**



Late or non-return of cups and shields will incorporate a **£250 fine**

CATTLE JUDGES

**Calf & Calf Handling, Young Handler, Local Dairy,
Best Local Beast, Holstein UK, Any Other Dairy Breed -**
Mr Charles George, Brynhyfryd, Wolfscastle, Haverfordwest

**Interbreed Pairs, Interbreed Champion Heifer,
Interbreed Champion Cow -**
Mr Derfel Harries, Llanon Villa, Manordeilo, Llandeilo SA19 7BG

Dragon JerseyFest, Jersey -
Mr Iwan Thomas, Llangennech
Entry forms and further information Huw Evans / Helen Carpenter -
07721 386617 / huw.auctioneer@hotmail.co.uk
Entries close Wednesday 10.05.2017 at 12 noon

Hereford - Mr Meurig Thomas, Clyncemes, New Moat, Clarboston Road

Beef Calf Handling - Mr Meurig Thomas, Clyncemes, New Moat,
Clarboston Road

Welsh Black - Mr Glyn Thomas, Aberdyfnant,
Llanddeusant, Llangadog, Carmarthen

Limousin, Commercial Beef -
Mr Craig Ingram, Rhonllwyn Farm, Llandegley, Llandrindod Wells, Powys

Any Other Continental Beef

Champion Beef Animal - t.b.c. **Any Other British Breed** - t.b.c.
Champion Dairy or Beef - t.b.c. **Supreme Champion Continental** - t.b.c.
Beef Pairs - t.b.c. **Any Other Beef** - t.b.c.
Holding Number - CPH 550208613

ALL EXHIBITORS BRINGING ANY TYPE OF BEDDING ARE KINDLY ASKED
TO TAKE IT HOME WITH THEM AFTER THE SHOW

IMPORTANT NOTICE

THE ST CLEARS YFC AGRICULTURAL SHOW IS EXEMPT FROM PRE-MOVEMENT TESTING

The St. Clears YFC Agricultural Show Committee has been advised by the Welsh Government that there are changes to the Pre-Movement Testing Policy in Wales which will come into force in mid May 2013. This exemption only applied when the animal returns to its original farm or is taken directly to slaughter.

We have been asked by the Welsh Government to let exhibitors know about the intended change in policy and to stress that:

- ☆ The Exemption from Pre-Movement Testing remains for shows where the cattle are not housed and are present for less than 24 hours
- ☆ Pre-Movement Testing is required where cattle are moved to shows that are held on multiple days and/or where cattle are housed.
- ☆ Any show where animals are sold or moved to premises other than the premises of origin or direct slaughter, continue to require Pre-Movement Testing, as before.

AND THAT

- ☆ Bovine TB has significant potential to disrupt and cause long lasting financial consequences to your business, so prevention from infection should always be your priority.
- ☆ All Cattle owners are recommended to undertake Pre-Movement Testing and ideally also voluntary post-movement testing of animals, to safeguard the health and high value of stock attending shows.

It is the committee's intention to include a full schedule for cattle, sheep and horses at the 2017 show.

PLEASE SUPPORT YOUR LOCAL SHOW

The St. Clears YFC Agricultural Show confirms that it will undertake to comply with all rules and conditions and obtain the necessary licence to hold these sections in accordance with the Animal Health Act and Orders appertaining at the time of the Show. Please make sure that you are fully aware of all conditions that will prevail on show day. Please ensure that your livestock vehicles are clean. Unclean vehicles will be refused entry into the show.

BE SEEN TO BE CLEAN

ADRAN GWARTHEG/ CATTLE SECTION

Holding Number – CPH 550208613

ONLY CATTLE FROM ACCREDITED HERDS WILL BE ALLOWED TO COMPETE IN THE DAIRY OR BEEF CLASSES. E.B.L. FACILITIES AVAILABLE

All exhibits must be properly haltered at all times (RULE 12).

Exhibitors **MUST** bring Cattle Passports

CALF & CALF HANDLING

Judge: Mr Charles George, Brynhyfryd, Wolfscastle, Haverfordwest

Entry Fee Class C1–C3: £1.50

Prizes for Classes C1–C3 1st: £6.00, 2nd: £4.00, 3rd: £2.00, 4th: Rosette

These Classes may be amalgamated if there are a small amount of entries,
at the Judges/Chief Stewards Discretion

- C1. Best Dairy Calf under 6 months old on day of show
- C2. Best Dairy Calf 6 - 9 months old on day of show
- C3. Best Dairy Calf 10 - 12 months old on day of show

Shield for the Best Dairy Calf (C1 – C3).

Champion Calf & Calf Handler 2016 - William Griffiths, Blaencorse, St. Clears

BEEF CALF HANDLING

Entry Fee Class C4: £1.50

Prizes for Class C4. 1st: £6.00, 2nd: £4.00, 3rd: £2.00, 4th: Rosette

Judge: Mr Meurig Thomas, Clyncemes, New Moat, Clarboston Road

- C4. Best Beef Calf under 12 months old on day of show

Robert Morgan Silver Challenge Cup for the Best Beef Calf (Class C4)
kindly donated by Robert Morgan, Penygraig, Llanddowror to be won three times
(not necessarily in succession) before becoming the winner's property

Champion Beef Calf Handling 2016 - Dylan Davies, c/o Pentre Farm, St. Clears

YOUNG HANDLER

Entry Fee Class C5–C7: £1.50

Prizes for Classes C5–C7 1st: £6.00, 2nd: £4.00, 3rd: £2.00, 4th: Rosette

Judge: Mr Charles George, Brynhyfryd, Wolfscastle, Haverfordwest

- C5. Best Handler, under 10 years old – *Rosettes for ALL*
Winner 2016 - Iwan Thomas, Llancwm, Llandyfaelog
- C6. Best Handler, 10 - 14 years old – *Rosettes for ALL*
Winner 2016 - Dylan Davies, c/o Pentre Farm, St. Clears
- C7. Best Handler, 15 - 18 years old – *Rosettes for ALL*
Winner 2016 - Iwan Thomas, Llancwm, Llandyfaelog

The Jenner Family Silver Challenge Shield for the Champion Handler (Classes C5–C7)
kindly donated by Mr David Jenner & Family, Pant-y-Waun, Cwmbach, Whitland
to be won three times (not necessarily in succession) before becoming the winner's property.

Champion Young Handler 2016 - Iwan Thomas, Llancwm, Llandyfaelog

DAIRY SECTION

These Classes may be amalgamated if there are a small amount of entries,
at the Judges/Chief Stewards Discretion

LOCAL DAIRY (Any Breed)

All Exhibitors must live within a 5 miles radius of St. Clears Post Office

Entry Fee for Classes C8-C12: £3.00

Prizes for Classes C8-C12 1st: £15.00, 2nd: £10.00, 3rd: £5.00, 4th: Rosette

Judge: Mr Charles George, Brynhyfryd, Wolfscastle, Haverfordwest

C8. Cow in Calf

C9. Heifer in Calf

C10. Cow in Milk

C11. Heifer in Milk

C12. Cow or Heifer to be **HOME BRED**

Elfyn Thomas Challenge Cup for the Best Local Dairy Champion (Classes C8-C12)
kindly donated by Mr & Mrs E. Thomas, Foxhole, St. Clears to be won three times
(not necessarily in succession) before becoming the winner's property.

Champion Local Dairy 2016 - Audrey Davies, Coomb Farm, Llangynog

BEST LOCAL BEAST

Entry Fee Class C13: £3.00

Prizes for Class C13 1st: £15.00, 2nd: £10.00, 3rd: £5.00, 4th: Rosette

Judge: Mr Charles George, Brynhyfryd, Wolfscastle, Haverfordwest

C13. Best Local Beast, any breed, Male or Female

The W. P. Davies Trophy (President 1987) for the Best Local Beast, (C13) any breed,
Male or Female kindly donated by the late Mr Penryth Davies, Penuwch, St. Clears

Champion Local Beast 2016 - Audrey Davies, Coomb Farm, Llangynog

HOLSTEIN U.K. & IRELAND ANY OTHER DAIRY BREED

These Classes may be amalgamated if there are a small amount of entries,
at the Judges/Chief Stewards Discretion

Entry Fee for Classes C14-C21: £5.00

Prizes for Classes C14-C21 1st: £15.00, 2nd: £10.00, 3rd: £5.00, 4th: Rosette

Judge: Mr Charles George, Brynhyfryd, Wolfscastle, Haverfordwest

C14. Cow in Calf - *Holstein UK & Ireland*

C15. Cow in Calf - *Any Other Dairy Breed*

C16. Heifer in Calf - *Holstein UK & Ireland*

C17. Heifer in Calf - *Any Other Dairy Breed*

- C18. Cow in Milk - *Holstein UK & Ireland*
 C19. Cow in Milk - *Any Other Dairy Breed*
 C20. Heifer in Milk - *Holstein UK & Ireland*
 C21. Heifer in Milk - *Any Other Dairy Breed*

Special Rosettes - Holstein U.K. & Ireland offer a Championship Award Rosette
 & Reserve Champion Rosette

Holstein U.K. & Ireland offer a Best Exhibitor Bred Rosette.

Holstein U.K. & Ireland offer a Best Udder in Show Rosette

Special Show Rosette for the Best Home Bred Animal in the Holstein Section

R. Silcox & Sons Perpetual Silver Challenge Cup for the Champion Holstein Heifer
Champion Holstein Heifer 2016 - Messrs E & C Thomas, Gelligatrog, Pontantwn, Kidwelly

The Reese Perpetual Silver Trophy for the Champion Holstein
 kindly donated by E. C. Reese, Rosebrook, Pwll Trap

Champion Holstein 2016 - Messrs E & C Thomas, Gelligatrog, Pontantwn, Kidwelly

The Elkington Challenge Cup for the Champion Any Other Dairy Breed
 kindly donated by Mr & Mrs Mark Davies, Troed y Rhiw, Llangynin

Champion Any Other Breed Heifer 2016 -

INTERBRED DAIRY PAIRS

Entry Fee Class C22: £5.00

Prizes for Class C22. 1st: £15.00, 2nd: £10.00, 3rd: £5.00, 4th: Rosette

Judge: Mr Derfel Harries, Llanon Villa, Manordeilo, Llandeilo SA19 7BG

C22. Interbred Dairy Pairs (Exhibitor to own Both Animals)

Champion and Reserve Champion Rosette

Glanmor Jersey Cup to be Presented for the Supreme Interbreed Dairy Heifer
 kindly sponsored by Glanmor Jerseys, Parcgwyn, Llandawke

Supreme Interbreed Dairy Heifer 2016 -

Llandyfaelog Show Champion of Champions

Sponsorship for the Champion Holstein and also Any Other Dairy Breed
 The Champion of each section will be eligible to compete at Llandyfaelog Show
 September 2017 (Ayrshire, Jersey, Guernsey, Brown Swiss & Dairy Shorthorn)

The Picton-Davies Perpetual Silver Cup for the **CHAMPION DAIRY ANIMAL**
 kindly donated by the late Mr & Mrs Dewi Picton-Davies, Asgoed, St. Clears
 for which the following Champions are eligible (Holstein, Jersey & Any Other Breed)

Champion Dairy Animal 2016 -

ALL EXHIBITORS BRINGING ANY TYPE OF BEDDING ARE KINDLY ASKED
 TO TAKE IT HOME WITH THEM AFTER THE SHOW

BEEF SECTION

HEREFORD

Entry Fee for Classes C23-C29: £5.00

Prizes for Classes C23-C29 1st: £15.00, 2nd: £10.00, 3rd: £5.00, 4th: Rosette

Judge: Mr Meurig Thomas, Clyncemes, New Moat, Clarbeston Road

- C23. Best Bull, born before 31st December 2015
- C24. Best Bull, born between 1st January & 31st August 2016
- C25. Best Bull Calf, born after 1st September 2016
- C36. Best Cow or Heifer in Milk or in Calf
- C27. Best Maiden Heifer
- C28. Best Heifer Calf, born after 1st September 2016
- C29. Best Pair (Male or Female) - ***Morris Powell Perpetual Trophy***

The Morris Powell Perpetual Memorial Trophy (C29) for the Champion Hereford Pair kindly donated by Mrs & Miss Powell, Llwyncelyn, Llanddowror

Champion Hereford Pair 2016 - Anthony John, Lacques Fawr, Llansteffan

The Vine Silver Challenge Cup for the Champion Hereford Male kindly donated by A. & J. D. John, Lacques Fawr, Llansteffan, kindly re-presented by J. M. & J. L. Strand, The Vine, Johnston, Haverfordwest to be won three times (not necessarily in succession) before becoming the winner's property.

Champion Hereford Male 2016 - F G Goodhall, Glyntywarch, Babel

Silver Challenge Cup for the Champion Hereford Female

Champion Hereford Female 2016 - Messrs Thorne, Studdolph Hall, Milford Haven

WELSH BLACK

Entry Fee for Classes C30-C34: £5.00

Prizes for Classes C30-C34 1st: £15.00, 2nd: £10.00, 3rd: £5.00, 4th: Rosette

Judge: Mr Glyn Thomas, Aberdyfnant, Llanddeusant, Llangadog, Carmarthen

- C30. Best Bull
- C31. Best Cow in Calf or in Milk
- C32. Heifer in Calf or in Milk
- C33. Best Maiden Heifer
- C34. Best Pair (Male or Female)

Bibby's Agriculture Perpetual Silver Cup for the Champion Welsh Black (C30-C34)

Champion Welsh Black 2016 - Ben Reynolds, Parcgywyn, Whitland

SOUTH WALES WELSH BLACK BREEDER' CLUB

This is a qualifying show for the Glyn Jones Junior Heifer Championship. (Maiden heifers born after 1st January 2016). This competition is sponsored by MR GLYN JONES, PENLON, NEBO, CROSS INN, CEREDIGION. This competition will now be run on a point system with Llandysul Show being a double point show. Qualifying shows for the Junior Heifer Championship are: Cothi Bridge, Llanddarog, Tivy-side, Cardigan, Llanilar, Aberystwyth, Nevern, Fishguard, Brecon, St. Clears, Llandeilo, Lampeter, Martletwy, Monmouth, Talybont, Llandysul and Gower

Further details available from Janet Thomas - 01558 668264.

SPECIAL AWARD This show is a qualifying show for the prestigious Welsh Black Cattle Society's 'Bull & Female of the Year award'

SMALL SHOWS COMPETITION

This show qualifies for the Small Shows and New Entrants competition - these competitions are sponsored by Miss. L HOWELLS, CWMCARNO, RHYMNEY, GWENT and the SOUTH WALES WELSH BLACK BREEDERS' CLUB.

Further details available from Janet Thomas 01558 668264

Qualifying shows for the Small Shows competition: Tivy-Side, Llanddarog, Cardigan, Llanilar, Nevern, Llandysul, St.Clears, Llandeilo, Gower, Fishguard and Llandyfaelog.

LIMOUSIN

Entry Fee for Classes C35-C39: £5.00

Prizes for Classes C35-C39 1st: £15.00, 2nd: £10.00, 3rd: £5.00, 4th: Rosette

Judge: Mr Craig Ingram, Rhonllwyn Farm, Llandegley, Llandrindod Wells, Powys

C35. Best Bull born after 1st January 2015

C36. Best Cow in Calf or Milk

C37. Best Heifer in Calf or Milk

C38. Best Maiden Heifer born after 1st January 2016

C39. Best Pair (Male or Female)

Wembley Garage Perpetual Silver Cup for the Champion Limousin (C35-C39) kindly donated by Mr Derek Jones, formerly Wembley Garage, St. Clears

Champion Limousin 2016 - T B & C D Griffiths, Brynderi, Llangain

SPECIAL ROSETTE

The British Limousin Cattle Society offer a Champion & Reserve Champion Rosette

Winner 2016 - T B & C D Griffiths, Brynderi, Llangain

ANY OTHER BRITISH BREED

Entry Fee for Classes C40-C43: £5.00

Prizes for Classes C40-C43 1st: £15.00, 2nd: £10.00, 3rd: £5.00, 4th: Rosette

Judge:

C40. Best Bull (Any Age)

C41. Best Cow or Heifer in Milk or Calf (Born on or before 31st December 2015)

C42. Best Heifer born in 2015

C43. Best Heifer born on or after 1st January 2016

A Perpetual Silver Cup for the Champion Any Other British Breed (C40-C43)

kindly donated by The Mousley Family in memory of the late Mr & Mrs George Davies, New House Farm, St. Clears

Champion 2016 - Deborah Whittle, Cilcrug Farm, Trawsmawr, Carmarthen

The above classes will be awarded points to qualify towards the B.W.C.S. National Bull, Cow & Heifer Competitions

ALL EXHIBITORS BRINGING ANY TYPE OF BEDDING ARE KINDLY ASKED TO TAKE IT HOME WITH THEM AFTER THE SHOW

ANY OTHER CONTINENTAL BEEF

Entry Fee for Classes C44-C47: £5.00

Prizes for Classes C44-C47 1st: £15.00, 2nd: £10.00, 3rd: £5.00, 4th: Rosette
Judge:

- C44. Best Bull
- C45. Best Cow or Heifer in milk
- C46. Best Maiden Heifer
- C47. Best Pair (Male or Female)

Wyevale Perpetual Silver Trophy for the Champion Any Other Beef (C44-C47)
kindly donated by Wyevale Garden Centre, Carmarthen

Champion Any Other Beef 2016 -

Miss Delyth Jones & Mr Ifor Davies, Penrhiwllan, Llandysul

The Cleddau Insurance Perpetual Cup for the **CHAMPION**
of the **CONTINENTAL CATTLE** for which the following champions are eligible:
Limousin (C35-C39), Any Other Beef (C40-C43), Continental Beef (C44-C47)

Champion Continental Cattle 2016 -

Miss Delyth Jones & Mr Ifor Davies, Penrhiwllan, Llandysul

COMMERCIAL BEEF

PENS WILL BE PROVIDED (All animals to be haltered)

Entry Fee for Classes C48-C52: £5.00

Prizes for Classes C48-C52 1st: £12.00, 2nd: £8.00, 3rd: £4.00, 4th: Rosette
Judge: Mr Craig Ingram, Rhonllwyn Farm, Llandegley, Llandrindod Wells, Powys

- C48. Best Local Heifer or Steer
- C49. Best Steer
- C50. Best Heifer
- C51. Best Pair (Male or Female)
- C52. Best Suckling Calf under 300kg

The Robert Morgan Perpetual Silver Tray for the Champion Commercial Beef
kindly donated by Robert Morgan, Penygraig, Llanddowror

Champion Commercial Beef 2016 - G D Jenkins, Pantyrodyn, Newcastle Emlyn

Beef Pairs Championship Rosette for which the following champions are eligible:
Hereford, Welsh Black, Limousin, Any Other Beef Breed, Commercial Beef

Winner 2016 - G D Jenkins, Pantyrodyn, Newcastle Emlyn

The Amroth Castle Perpetual Silver Cup for the Supreme Champion Beef Animal
kindly donated by Mr Owen Phillip Esq MP for which the following Champions are eligible:
Continental Cattle, Welsh Blacks, Hereford & Commercial Beef

Supreme Champion Beef Animal 2016 - G D Jenkins, Pantyrodyn, Newcastle Emlyn

The O. J. Williams Silver Challenge Cup
for the **SUPREME CHAMPION DAIRY OR BEEF ANIMAL 2016 -**
E & C Thomas, Gelligatrog, Pontantwn, Kidwelly

DRAGON



JERSEYFEST

**SOUTH WALES JERSEYS
DE CYMRU**

Judging to start at 10.00am

Judge: Mr Iwan Thomas, Llanguennech

Entry forms & further information

Huw Evans / Helen Carpenter - 07721 386617 /

huw.auctioneer@hotmail.co.uk

Entries close Wednesday 10.05.2017 at 12 noon

SHOWMANSHIP - Entry Fee: Free

DF1. Handler 10 years old and under on day of show

DF2. Handler 16 years old and under on day of show

DF3. Handler 21 years old and under on day of show

DF4. Handler 26 years old and under on day of show

Prizes 1st £10 2nd £8, 3rd £5

Champion Handler - Prize kindly sponsored by Nicel Jerseys

Reserve Champion - Society tie kindly donated by Batchelor family, Chapel Jerseys

(DF5 - DF8) - Entry Fee: £4.00

Prizes 1st £15.00, 2nd £10.00, 3rd £5.00

DF5. Heifer born on or after 1st October 2016

DF6. Heifer born on or after 1st March 2016 and on or before 30th September 2016

DF7. Heifer born on or after 1st September 2015 and on or before 28th February 2016

DF8. Heifer born on or after 1st April 2015 and on or before 31st August 2015 - not calved

*The organisers reserve the right to sub-divide these classes
in age order if numbers entered warrant it*

Champion Calf will receive The Jerseys De Cymru Trophy

OPEN (DF9 - DF12)

DF9. Heifer in Milk - Entry Fee - £7.00

Prizes 1st £15.00, 2nd £10.00, 3rd £5.00

Champion Heifer will receive the Bibby Feeds Tankard

DF10. Dry Cow - Entry Fee - £4.00

Prizes 1st £15.00, 2nd £10.00, 3rd £5.00

DF11. Cow in Milk (2nd & 3rd Calver) Entry Fee - £7.00

Prizes 1st £15.00, 2nd £10.00, 3rd £5.00

DF12. Senior Cow in Milk (4th Calver or over) Entry Fee - £7.00

Prizes 1st £30.00, 2nd £20.00, 3rd £10.00

**CHAMPION WILL HAVE A PHOTOGRAPH KINDLY DONATED BY LUCINDA MORGAN
& THE MOLEVALLEY FARMERS TROPHY**

BEST UDDER WILL RECEIVE AN AWARD KINDLY DONATED BY GLANMOR JERSEYS

**EXHIBITOR BRED WILL RECEIVE THE IAN PLUMB MEMORIAL TROPHY -
KINDLY DONATED BY MRS SUE PLUMB**

DEFAID / SHEEP SECTION

Holding Number - CPH 550208613

Chief Stewards Sheep Section

Mrs Heulwen Rees, Rosebrook, Pwll Trap, St. Clears
Mrs Lynne Thomas, Foxhole, St. Clears
Mr Gareth Phillips, Ysgubor Fawr, Pwll Trap, St. Clears
Mr Dewi Thomas, Cildywyll, Llanddowror, St. Clears



PLEASE STATE ON ENTRY FORM IF M.V. ACCREDITED
(Exhibitors without their M.V. Certificates will not be issued with numbers)

Entry Fee (Classes S1 & S2, S5 - S41): £2
Prizes (Classes S1 & S2, S5 - S41): 1st-£10, 2nd-£6, 3rd-£4, 4th-Rosette

Entry Fee (Classes S3 & S4): £1.50
Prizes (Classes S3 & S4): 1st-£6, 2nd-£4, 3rd-£2. Rosettes for all entries

ALL LAMBS TO BE BORN WITHIN BREED SOCIETY RULES.
PRESENTATION OF CUPS WILL IMMEDIATELY FOLLOW THE JUDGING
OF THE SUPREME CHAMPION SHEEP

SHEEP TIMETABLE

11.00am Local Sheep,
Suffolk,
Any Other British Lowland,
Texel,
Butchers Lambs, Charollais
Any Other Continental
Badger Face Welsh Mountain,
Young Handler

2.00pm Champion Group of Three,
Supreme Champion Sheep

SHEEP

SHEEP JUDGES

Local Sheep, Suffolk -

Mr Eddie Morris, Wood Office, Cold Blow, Narberth

Texel - Mr A Davies, 4 Gorsddu Terrace, Penygroes, Llanelli, Carmarthenshire.
(IFFY DDU)

Charollais - Mr Owen Williams, Lower Sodbury Farm,
Walwyns Castle, Haverfordwest

Any Other Hill Breed - Mr Rhys Evans, Hafan Glyd, Esgair, Cynwyl Elfed

Any Other Continental Breed - Mr Lionel Organ, Ty Maen, Rhos, Llangeller

Any Other British Breed - Mr Rhys Evans, Hafan Glyd, Esgair, Cynwyl Elfed

Badger Face - t.b.c.

Butcher's Lambs - t.b.c.

Young Handler - Show President 2017: Mr Edward & Mrs Paula Thomas

Group Of Three & Supreme Champion - Mr D Morris, Oesty Farm, St. Clears

A separate area will be provided for entries from Maedi Visna Accredited Flocks.

Please state on the Entry Form whether Accredited or otherwise.

A VALID COPY OF THE M.V. CERTIFICATE MUST ACCOMPANY THE ENTRY FORM.

If flock owners do not indicate then they may find that there are no facilities
for them on the Show Day.

All Exhibitors wishing to gain entry into the approved section must produce an
official certificate of M.V. Status (SH20) for Inspection by the Show Steward.

ALL EXHIBITORS BRINGING ANY TYPE OF BEDDING ARE KINDLY ASKED
TO TAKE IT HOME WITH THEM AFTER THE SHOW

DEFAID/ SHEEP SECTION

LOCAL SHEEP (Any Breed)

All Exhibitors must live within a 5 mile radius of St. Clears Post Office

Entry Fee for Classes S1 & S2: £2.00

Prizes for Classes S1 & S2: 1st:£10.00, 2nd:£6.00, 3rd: £4.00, 4th: Rosette

A VALID COPY OF THE M.V. CERTIFICATE MUST ACCOMPANY THE ENTRY FORM

Judge: Mr Eddie Morris, Wood Office, Cold Blow, Narberth

- S1. Best Untrimmed Single Female
- S2. Best Untrimmed Ram or Ram Lamb

The Dewi & Meinir Thomas Silver Challenge Cup for the Local Champion (Classes S1 & S2).
To be won three times (not necessarily in succession) before becoming the winner's property

Local Sheep Champion 2016 - Menna Thomas, Foxhole Farm, St. Clears

YOUNG HANDLER

Entry Fee for Classes S3 & S4: £1.50

Prizes for Classes S3 & S4 1st: £6.00, 2nd: £4.00, 3rd: £2.00 - Rosettes for all entries

A VALID COPY OF THE M.V. CERTIFICATE MUST ACCOMPANY THE ENTRY FORM

Judge: 2017 Show President -

Mr Edward & Mrs Paula Thomas, Trefenty Farm, St. Clears

- S3. Young Handler (Under 11 years old) Rosette for All
Winner 2016 - Osian Thomas, Foxhall, St. Clears
- S4. Young Handler (11 - 16 years old) Rosette for All
Winner 2016 - Steffan Thomas, Orlwyn, Cwmffrwd, Carmarthen

A Silver Challenge Cup For the Best Young Handler (Classes S3 & S4)
kindly donated by RJP Engineering, St. Clears.

To be won three times (not necessarily in succession)
before becoming the winner's property

Young Handler Champion 2016 - Steffan Thomas, Orlwyn, Cwmffrwd, Carmarthen

SUFFOLK SHEEP

Entry Fee for Classes S5-S9: £2.00

Prizes for Classes S5-S9 1st:£10.00, 2nd:£6.00, 3rd: £4.00, 4th: Rosette

A VALID COPY OF THE M.V. CERTIFICATE MUST ACCOMPANY THE ENTRY FORM

Judge: Mr Eddie Morris, Wood Office, Cold Blow, Narberth

- S5. Single Ewe, any age.
- S6. Single Ewe Lamb
- S7. Best Ram, one year old or over
- S8. Best Ram Lamb, born ON or after 1st December 2016

S9. Group of Three

A Silver Perpetual Challenge Cup for the Champion Suffolk (S5 – S9) kindly donated by the late Mr & Mrs Bryant Rees, Avola, Red Roses.

Champion Suffolk 2016 - Christine Vaughan, Penlan, Crymych

SPECIAL ROSETTE - The Suffolk Sheep Society offers a Special Rosette for the Best Exhibit
Winner 2016 - Christine Vaughan, Penlan, Crymych

TEXEL SHEEP

Entry Fee for Classes S10-S14: £2.00

Prizes for Classes S10-S14. 1st:£10.00, 2nd:£6.00, 3rd: £4.00, 4th: Rosette

A VALID COPY OF THE M.V. CERTIFICATE MUST ACCOMPANY THE ENTRY FORM

Judge: Mr A Davies, 4 Gorsddu Terrace, Penygroes, Llanelli, Carmarthenshire (IFFY DDU)

S10. Single Ewe, any age.

S11. Single Ewe Lamb

S12. Best Ram, one year old or over

S13. Best Ram Lamb, born ON or after 1st December 2016

S14. Group of Three

A Silver Perpetual Challenge Cup for the Champion Texel (S10 – S14) kindly donated by Mrs Bill John and the late M Bill John, Pantyderi, Whitland (Past Chairman and Chief Steward Sheep Section)

Champion Texel 2016 - Lowri Reed, Tyngwndwn, Cross Inn, Llannon

SPECIAL ROSETTE -

The Texel Sheep Society offers a Champion & Reserve Rosette
Winner 2016 - Messrs Reed, Tyngwndwn, Cross Inn, Llannon

CHAROLLAIS SHEEP

Entry Fee for Classes S15-S19: £2.00

Prizes for Classes S15-S19. 1st:£10.00, 2nd:£6.00, 3rd: £4.00, 4th: Rosette

A VALID COPY OF THE M.V. CERTIFICATE MUST ACCOMPANY THE ENTRY FORM

Judge: Mr Owen Williams, Lower Sodbury Farm, Walwyns Castle, Haverfordwest

S15. Single Ewe, any age.

S16. Single Ewe Lamb

S17. Best Ram, one year old or over

S18. Best Ram Lamb, born ON or after 1st December 2016

S19. Group of Three

The Taf Insurance Silver Perpetual Cup for the Champion Charollais (S15 – S19)

Champion Charollais 2016 - E & G Gibbin, Drefach, Henllan Amgoed

The Charollais Sheep Society offers a Champion Rosette
Winner 2016 - E & G Gibbin, Drefach, Henllan Amgoed

BADGER FACE WELSH MOUNTAIN

Entry Fee for Classes S20-S24: £2.00

Prizes for Classes S20-S24. 1st:£10.00, 2nd:£6.00, 3rd: £4.00, 4th: Rosette

A VALID COPY OF THE M.V. CERTIFICATE MUST ACCOMPANY THE ENTRY FORM

Judge:

- S20. Single Ewe, any age.
- S21. Single Ewe Lamb
- S22. Best Ram, one year old or over
- S23. Best Ram Lamb, born ON or after 1st December 2016
- S24. Group of Three

A Silver Perpetual Challenge Cup for the Champion Badger Face Welsh Mountain (S20 – S24)
kindly donated by Mr & Mrs Parry, Erw Lon, Llangynnin, St. Clears

Champion Badger Face 2016 - Cathryn Jones, Capel Tydist, Bethlehem, Llandeilo

ANY OTHER HILL BREED

Entry Fee for Classes S25-S29: £2.00

Prizes for Classes S25-S29. 1st:£10.00, 2nd:£6.00, 3rd: £4.00, 4th: Rosette

A VALID COPY OF THE M.V. CERTIFICATE MUST ACCOMPANY THE ENTRY FORM

Judge: Mr Rhys Evans, Hafan Glyd, Esgair, Cynwyl Elfed

- S25. Single Ewe, any age.
- S26. Single Ewe Lamb
- S27. Best Ram, one year old or over
- S28. Best Ram Lamb, born ON or after 1st December 2016
- S29. Group of Three

A Silver Perpetual Challenge Cup for the Champion Any Other Hill Breed (S25 – S29)
kindly donated by Mrs D. Morgan (née John) Johnstown, Carmarthen

Champion Any Other Hill Breed 2016 - Steffan Thomas, Orllwyn, Cwmffrwd, Carmarthen

ANY OTHER CONTINENTAL BREED

Entry Fee for Classes S30-S34: £2.00

Prizes for Classes S30-S34. 1st:£10.00, 2nd:£6.00, 3rd: £4.00, 4th: Rosette

A VALID COPY OF THE M.V. CERTIFICATE MUST ACCOMPANY THE ENTRY FORM

Judge:

- S30. Single Ewe, any age.
- S31. Single Ewe Lamb
- S32. Best Ram, one year old or over
- S33. Best Ram Lamb, born ON or after 1st December 2016
- S34. Group of Three

A Silver Perpetual Challenge Cup for the Champion Any Other Continental Breed (S30 – S34)

Champion Any Other Continental Breed 2016 - Ryan Lee, c/o Forest Farm, Whitland

ANY OTHER BRITISH BREED

Entry Fee for Classes S35-S39: £2.00

Prizes for Classes S35-S39 1st:£10.00, 2nd:£6.00, 3rd: £4.00, 4th: Rosette

A VALID COPY OF THE M.V. CERTIFICATE MUST ACCOMPANY THE ENTRY FORM

Judge: Mr Rhys Evans, Hafan Glyd, Esgair, Cynwyl Elfed

S35. Single Ewe, any age.

S36. Single Ewe Lamb

S37. Best Ram, one year old or over

S38. Best Ram Lamb, born ON or after 1st December 2016

S39. Group of Three

The Rosebrook Perpetual Challenge Cup for the Champion Any Other British Breed (S35 – S39)

kindly donated by Mrs Heulwen Reese, Rosebrook, Pwll Trap, St. Clears

Champion Any Other British Breed 2016 - E B & S Jones, Maesglas, Wolfscastle

BUTCHER'S LAMBS (Any Breed)

Entry Fee for Classes S40-S41: £2.00

Prizes for Classes S40-S41 1st:£10.00, 2nd:£6.00, 3rd: £4.00, 4th: Rosette

A VALID COPY OF THE M.V. CERTIFICATE MUST ACCOMPANY THE ENTRY FORM

Judge:

S40. Best Pair of Untrimmed Butcher's Lambs (not exceeding 30kgs-live weight)

S41. Best Pair of Untrimmed Butcher's Lambs (exceeding 30kgs-live weight)

The Malcolm Evans Silver Challenge Cup for the Champion Butcher's Lambs (S40 – S41)

Champion Butcher's Lambs 2016 - Messrs Windsor, Forest Farm, Whitland

GROUP OF THREE CHAMPIONSHIP

Judge: Mr Eddie Morris, Wood Office, Cold Blow, Narberth

The following are eligible: Winners from classes S9, S14, S19, S24, S29, S34 & S39.

CHAMPIONSHIP ROSETTE:

Winner 2016 - E B & S Jones, Maesglas, Wolfscastle

SUPREME CHAMPION SHEEP

Judge:

A Silver Challenge Cup for the SUPREME CHAMPION SHEEP

kindly donated by R. L. & J. M. Davies, Moelfryn Mawr, Llanon, Ceredigion.

The following Champions are eligible Suffolk, Texel, Charollais,

Badger Face & Any Other Continental / British Breeds

Supreme Champion Sheep 2016 - E & G Gibbin, Drefach, Henllan Amgoed

PRESENTATION OF CUPS WILL IMMEDIATELY FOLLOW

THE JUDGING OF THE SUPREME CHAMPION SHEEP

The Merydd Silver Challenge Cup for the Highest Number of Points in the Sheep Classes

kindly donated by Mr Russell T. Davies, Rhydymerydd, Clunderwen

Highest Points -

ALL EXHIBITORS BRINGING ANY TYPE OF BEDDING ARE KINDLY ASKED
TO TAKE IT HOME WITH THEM AFTER THE SHOW

FORAGE SECTION

ALL ENTRIES TO BE EXHIBITED IN THE GENERAL SECRETARY'S TENT

Judge: Mr Edward Thomas, President 2017

TO COMMENCE AT 11.00am

Quantity: Small Bag of Silage / Half Bale of Hay

Entry Fee for Classes F1-F5: £1.00

Prizes for Classes F1-F5: 1st: £5.00, 2nd:£3.00, 3rd: £2.00, 4th: Rosette

- F1. Sample of Clamp Silage
- F2. Sample of Round Bale Silage
- F3. Sample of Hay
- F4. Best Sward, New Ley (12" x 12")
- F5. Best Sward, Permanent Ley (12" x 12")

A Silver Trophy to the Best Exhibit in Classes F1, F2 & F3 kindly donated by "Daimer Feeds Ltd". **Winner 2016 - Messrs Griffiths, Blaencorse, St. Clears**

VINTAGE SECTION

Entry Fee for Classes: V1 - V4 £2.50

Prizes for Classes V1-V4: 1st: £11.00, 2nd:£5.50, 3rd: £3.50, 4th: Rosette

VINTAGE PARADE WILL TAKE PLACE AT 2.00pm PROMPT

Judge: Mr Huw Thomas, Bryngwelltyn, Whitland

TO COMMENCE AT 11.30am

- V1. Best Vintage Tractor Pre 1959
- V2. Best Classic Tractor 1960 - 1975
- V3. Best Stationary Engine Pre 1945
- V4. Best Vintage Horticultural or Agricultural Implement



The Mark Rees Shield kindly donated in memory of the late Mr Mark Rees, formerly of Cethin Farm, St. Clears by Mrs Val Rees

Winner 2016 - Mr Lloyd Davies, Erw Las, St. Clears

COMPANION DOG SHOW

Dog Show Judge: Mr Huw Bishop, 217 Waterloo Road, Penygroes, Llanelli

Judging to commence at 1.00 p.m

Pedigree Dogs Only

Any Breed of Dog docked on or after 28th March 2007 cannot exhibit at this Show

Prizes for Classes D1-D4 1st: £3.00 & Rosette, 2nd, 3rd & 4th: Rosettes

NO ENTRY FEE - COMPETITORS TO PAY FULL ENTRY AT GATE

Held under Kennel Club Rules. Exhibits do not have to be registered

DOG SHOW SECRETARY: To be confirmed

- D1. AV - Puppy 6 - 12 months
- D2. AV - Working
- D3. AV - Non-Working
- D4. AV - Open



A Silver Cup for the Best in Show.

To be won three times (not necessarily in succession) before becoming the winner's property. Best in Show & Reserve will not be eligible to compete in this section

Winner 2016 - Mrs V Burke, Brynhawddgar, Mynyddcerrig, Llanelli

NOVELTY SECTION

To include Cross-Bred & Mongrel Exhibits

Prizes for Classes D5-D15: 1st-£1.00 & Rosette, 2nd, 3rd & 4th: Rosettes

- D5. Best Veteran over 7 years
- D6. Best Long Coat
- D7. Best Short Coat
- D8. For the Dog with the most appealing eyes
- D9. For the Dog with the most wagging tail
- D10. Best Fancy dressed dog
- D11. Best six legs
- D12. Best unusual Brace
- D13. Best Child handler, 11 years and under
- D14. Best Child Handler, 11 to 16 years
- D15. Dog the judge would like to take home

SHOW DAY COMPETITION

T1. THE BEST TRADE STAND On the Show Field

For the Best Trade Stand Cup
kindly presented by the Santa Clara, St. Clears

TRADE STAND OUTSIDE

T2. THE BEST HANDICRAFT STALL In the Exhibition Shed

T3. THE BEST FOOD STALL In the Exhibition Shed

The President and the Trade Stand Secretary
will judge the competition at 11.30am
The result will be announced at 1.00 p.m.

CEFFYLAU / HORSES TIMETABLE

RING 1 - 9.00am prompt will follow on

IN HAND HUNTERS (P1-P4) VETERANS (P5-P6)
RACE TO RIDING HORSE (P7-P8) RIDDEN HUNTERS (P9-P14)
SIDE SADDLE (P15-P16)

RING 2 - 9.30am prompt will follow on

LOCAL HORSE (P17-P18) IN HAND PONY BREEDING (P19-P21)
SHETLAND PONIES (P22-P27) COLOURED (P28-P31)
PURE WELSH RIDDEN (P32-P35)

RING 3 - 10.00am prompt will follow on

WELSH SECTION A (P36-P41) WELSH SECTION B (P42-P47)
WELSH SECTION C (P48-P53) WELSH SECTION D (P54-P59)

RING 4 - 10.00am prompt will follow on

BSPS SHOW PONY (P60-P61) BSPS OPEN SHOW PONY (P62-P64)
BSPS SHOW HUNTER PONY (P65-P66)
BSPS OPEN SHOW HUNTER PONY (P67-P71)
BSPS HERITAGE MOUNTAIN AND MOORLAND RIDDEN (P71-P73)

RING 5 - 9.00am prompt will follow on

PALOMINO & DUNS (P74-P75)
IN HAND MOUNTAIN & MOORLAND (P76-P78)
RIDDEN MOUNTAIN AND MOORLAND (P79-P82) ARABS (P83-P86)
REGISTERED WELSH PART BRED IN HAND & RIDDEN (P87-P91)

RING 6 - 8.30am prompt will follow on

BSPS OPEN CRADLE STAKES - PONY NOT EXCEEDING 122cms (P92)

BSPS OPEN NURSERY - PONY NOT EXCEEDING 133cms (P93)

BSPS NOVICE NOT EXCEEDING 133cms (P94)
BSPS NOVICE NOT EXCEEDING 143cms (P95)
BSPS NOVICE NOT EXCEEDING 153cms (P96)
BSPS NOVICE NOT EXCEEDING 158cms (P97)

BSPS OPEN WORKING HUNTER - NOT EXCEEDING 133cms (P98)
BSPS OPEN WORKING HUNTER - NOT EXCEEDING 143cms (P99)
BSPS OPEN WORKING HUNTER - NOT EXCEEDING 153cms (P100)
BSPS OPEN WORKING HUNTER - NOT EXCEEDING 158cms (P101)

BSPS HERITAGE OPEN MOUNTAIN AND MOORLAND -
NOT EXCEEDING 122cms (P102)
BSPS HERITAGE OPEN MOUNTAIN AND MOORLAND -
NOT EXCEEDING 133cms (P103)
BSPS HERITAGE OPEN MOUNTAIN AND MOORLAND -
NOT EXCEEDING 143cms (P104)
BSPS HERITAGE OPEN MOUNTAIN AND MOORLAND -
EXCEEDING 143cms (P105)

NOVICE WORKING HUNTER HORSE EXCEEDING 15 H.H. -
NOT TO HAVE WON A FIRST PRIZE IN A WH CLASS. (P106)

BEST OPEN WORKING HUNTER HORSE EXCEEDING 15 H.H (P107)

MAIN GRANDSTAND RING - 4.30pm
Supreme Champion Horse

All Silverware will be presented after the judging
of the Supreme Champion Horse and not before.
Those who do not wish to take part must have informed the Section
Secretary and will forfeit the right to any Trophies won.

THE EQUITY & LAW PERPETUAL SILVER TROPHY
For the Supreme Champion Horse/Pony

PLEASE NOTE RINGS CAN BE CHANGED AT THE DISCRETION
OF THE CHIEF STEWARD ON THE DAY

SILVERWARE

Please return all Silverware won in 2016 by **1st April, 2017.**



Late or non-return of cups and shields will incorporate a **£250 fine**



CHIEF STEWARDS HORSE & PONY SECTION

Mr Phillip Morgan, M.R.C.V.S, St. Clears
Mr Mark Davies, Troedyrhiw, St. Clears



Announcer:

Mr & Mrs S. W. R. Michell M.R.V.C.S.
Show President 2012

Secretaries Tent:

Alison Ebsworth, General Secretary
Elizabeth Thomas, Rhian Williams
David Parry Williams – Treasurer

Stewards:

Rhys Parry Williams, Sarah Phillips, Elizabeth Carrol,
Malcolm Evans, Anna Phillips, Eleanor Phillips, Helen Llewellyn Griffiths,
Lucy Llewellyn Griffiths, Heledd Ebsworth, Rachel Ebsworth,
Nigel Lewis, Carolin Gibbs, Liwsi Ebsworth

HORSE & PONY JUDGES

RING 1

In-Hand Hunter
Veterans

Race To Riding Horse

Ridden Hunter

Ridden Hunter Confirmation Judge

Side Saddle

Mr Vernon Beynon, Cross Farm, Clynderwen

Mrs A W Burrington, Blagdon House,
Wheddon Cross, nr. Minehead, Somerset

To be confirmed

To be confirmed

RING 2

Local Horse

In Hand Pony Breeding

Shetland Pony

Coloured Horse

Pure Bred Welsh Ridden

Mrs Emma Courtney-Roberts, 1 Pleasant Villas,
Pontarddulais, Swansea

Mrs Rosemary Rees, Lower Hausguard Farm
Haverfordwest, Pembrokeshire

Rachel Morgans, 17 Cadwgan Road,
Craig Cefn Parc, Clydach, Swansea

RING 3

Welsh Section A

Welsh Section B

Welsh Cob Section C

Welsh Cob Section D

Mrs T Hook, Twyn-Yr-Hebog, Station Road
Gilwern, Gwent (KEMYSFAWR)

Miss D Everitt, Brynglas, Llangadog,
Carmarthenshire (DYRFAL)

RING 4

BSPS Open L/R & F/R Show Pony	Bryony Lovell-Williams, Ty Ffynnon Cottage,
BSPS Open Show Pony	Crickhowell Road, Gilwern, Abergavenny
BSPS Show Hunter Pony	
BSPS Open Show Pony	
BSPS Heritage Mountain & Moorland (Ridden)	Mrs R Rees, Small Land Stud, Meidrim Carmarthen (SMALL-LAND)

RING 5

Unaffiliated Palominos & Duns	To be confirmed
In Hand Mountain & Moorland	Claire Parsons, Little Skirrid Farmhouse
Ridden Mountain & Moorland	Coldbrook, Abergavenny, Gwent
Arabs	Mrs Kath Hall, Bank Farm, Trefasser,
Registered Welsh Part Bred In Hand	Goodwick, Fishguard

RING 6

BSPS Working Hunter	Mrs D L Partridge, Rosedale Stud, Gelli Fawr Farm, Henllys, Cwmbran (ROSEDALE) Mr Anthony Williams, Skerryback, St. Ishmaels, Haverfordwest
Heritage Open Working WHP	Mrs D L Partridge, Rosedale Stud, Gelli Fawr Farm, Henllys, Cwmbran (ROSEDALE)
WHP Course Builder	Mr Stephen Craddock, Hollybush Farm, Spalling Down, Cowbridge

SUPREME CHAMPION HORSE MAIN RING 4.30pm approx

2017 - All Silverware will be presented after the judging of the Supreme Champion Horse and not before. Those who do not wish to take part must inform the Horse Section Secretary and will therefore forfeit the right to any Trophies won.

THE EQUITY & LAW PERPETUAL SILVER TROPHY

for the Supreme Champion Horse/Pony

OVERALL SUPREME HORSE/PONY 2016 -

Dhaka Dazzle

Abbie Dark, Crofty, Swansea

BSPS Open Show Hunter Champion 2016

Race to Riding Horse 2016

SUPREME HORSE JUDGE 2017

Mr Christopher Jones, Llanri Stud, 2 Maes Y Coleg, Llandovery

ST. CLEARS SHOW'S HORSE AND PONY AFFILIATIONS 2017

British Show Pony Society (BSPS) No 147/17

www.bsps.org.uk

This show is affiliated to the "British Show Pony Society" (BSPS) and all persons entering, competing, showing or otherwise taking part in BSPS classes, whether or not members, **ARE SUBJECT TO THEIR CONSTITUTION AND RULES** including the disciplinary procedures and shall be deemed to have consented to the jurisdiction of the B.S.P.S. Exhibitors, who have never been members, are allowed 7 days in which they can apply for membership and register their ponies. Provided the animal is registered in accordance with RULES 23 and 28, and ridden by a BSPS MEMBER

- Open Mini Show Pony will qualify for the BSPS Binks Champion of Champions
- Show Pony Champion qualifies for the BSPS Binks Family Champion of Champions
- INT Champion qualifies for the BSPS Binks Family Champion of Champions
- Show Hunter Pony Champion qualifies or the BSPS Binks Family Champion of Champions
- Mini Working Hunter Champion qualifies for the BSPS "White Company Champion of Champions
- Working Hunter Champion qualifies for the BSPS Binks Family Champion of Champions

BSPS Rule 516 in the 2017 BSPS Rule & Show handbook

B.S.P.S Challenge

Open Lead Rein, First Ridden, Show Pony, SHP , WHP , Cradle Stakes, Nursery Stakes, Int SRT, SH, WH and Heritage M&M Lead rein, First Ridden, Ridden & WHP .This show is a qualifier for the BSPS Challenge. Animals must qualify for the challenge by attending any BSPS affiliated show and competing in the appropriate class. Ponies must not have qualified for the 2017 Horse of The Year show in the appropriate class.

B.S.P.S. Premier League. (All Shows affiliated to the B.S.P.S. with Open Classes that are NOT qualifiers for the R.I.H.S. or the H.O.Y.S.): This show is a qualifier for the "B.S.P.S. Premier League", 1st, 2nd, 3rd & 4th placed ponies in the Lead Rein, First Ridden, Lead Rein of Hunter Type, Cradle Stakes, Intermediate S.R.T., W.H. and S.H.

B.S.P.S. Black Country Saddles Best Rider.

This Show is a qualifier for the "B.S.P.S Best Rider of the Year", the Best Rider in the Open Lead Rein, First Ridden, Open Lead Rein Hunter Type 128cms, 138cms and 148cms. Show Pony the 122cms, 133cms, 143cms & 153cms. SHP, the Cradle and Nursery stakes, the 133cms, 143cms and 153cms. WHP Intermediate, SRT, SH & WH classes and Open Heritage Lead Rein, First Ridden and to the Best Rider 25 years and under in the Heritage Ridden and WHP classes will receive a Card and qualify for the final at the BSPS Summer Championship Show. See BSPS Rule 455

THE SHETLAND PONY STUD BOOK SOCIETY

www.shetlandponystudbooksociety.co.uk

These classes are confined to Registered Ponies. Ponies must be named and registration numbers shown on the entry form and in the Catalogue. Shetland Pony Society rosettes will only be given to ponies registered with the society or eligible for registration (i.e. Foals). Three year old fillies with foals at foot may not be shown. All foals must be a minimum of 3 weeks old on the day of the show. There are to be NO Colts or Entire Males in Young Handler Classes. Children under 14 years old may not show Colts, (excluding foals) or entire males in In-Hand classes. Children under 11 years old on the day of the show may not show entire males in ridden classes. In the interest of safety, hard hats must be worn by all handlers, aged 14 years or under in In-Hand classes and by all exhibitors, irrespective of age in ridden class

WELSH PONY and COB SOCIETY (WPCS) BRONZE MEDALS

St. Clears Show is affiliated to the Welsh Pony & Cob Society and is a Bronze Medal Show which will be awarded (members only) to the Champions or Reserve in Sections A, B C & D In Hand Classes ONLY respectively, according to the society's regulations. Ponies must be registered and exhibits catalogued/official show documentation to be eligible. This show will **NOW** be able to accept entries on the day AT AN ADDITIONAL COST OF £2.50 PER ANIMAL PER CLASS.

"Welsh Pony & Cob Society Incentive Scheme - Overall Gelding Champion and Reserve to be competed for by the highest placed gelding from each appropriate class within the Section A-B-C-D generously sponsored by the Millcroft Stud. (Section A - *P38, *P39, *P41 Section B - *P44, *P45, *P47, Section C - *P50, *P51, *P53, Section D - *P56, *P57, *P59)

National High Point Junior Gelding of the Year open to all geldings three years of age and under shown in hand with points gained throughout the year. Free competition, cards are available for owners to complete from the Welsh Pony & Cob Society

DYFED WELSH PONY & COB ASSOCIATION

Dyfed Welsh Pony & Cob Association and Carmarthen Welsh Pony & Cob Association "Points Award Scheme" for the following sections: In Hand, Ridden and Part Bred.

2017 THE NATIONAL WELSH SUPREME CHAMPIONSHIP SHOW

QUALIFIER 6th AUGUST 2017 - THREE COUNTIES SHOWGROUND, MALVERN, WORCESTERSHIRE

This show is a qualifier for the National Welsh "Brightwells" In hand championships (A, B, C, D & WP-BR In Hand) and the National Welsh "Brynseion" Stud Ridden championships (A, B, C, D & WP-BR). This show is a qualifier for the National Welsh "Brynseion" Lead Rein championship and The National Welsh "Brynseion" First Ridden championship. Please contact Mr. David Blair for the National Welsh Championship show on david@waxwingponies.com or telephone 01383 851732

THE NATIONAL WELSH "BRYNSEION STUD RIDDEN WELSH CHAMPIONSHIP

The National Welsh "Brynseion" First Ridden Championship. The 2 highest placed Welsh Section A or B ponies will qualify for this Championship.

The National Welsh Sarum Investments Ltd., Gelding Championship. The Highest placed gelding in each class including part breeds where geldings are eligible

The National Supreme "Brynseion" Stud Ridden Championship - both the Champion and Reserve in the Ridden Sections for the A, B, C & D will qualify for these Championship at the Three Counties, Malvern. In the event of either having previously qualified then the qualification will pass to the 2nd Reserve in the Championship.

The National Ridden Ridden Welsh Part-Bred Championship - NB: As this is just 1 Supreme championship 2 x qualifications are offered in each of the following (a) WP-BR under 14.2hh (b) WP-BR over 14.2hh

Details from Secretary Mrs D L Partridge - 01633 482365

TSR In Hand Qualifiers and TSR Ridden Champs Qualifiers

TR Riders & In Hand Regional Finals. This show is a qualifier for the 2016 TSR Regional Finals. Qualify and enter ANY of the Regional Finals Central, East Anglia, North West, North East, South East, Wales & South West or Scottish. You do not have to be a TSR member to qualify or enter a final. The Rider/Handler qualifies and can enter any horse/pony in any number of finals. TSR Riders Final - 1st & 2nd Riders qualify and will receive a qualification card in the ring. TSR In Hand Finals - The two highest placed Handlers with a TSR In Hand Card will qualify in any In Hand Class. Handlers MUST have their cards signed in the ring by the Judge/Steward.

Full details www.theshowingregister.co.uk

RING 1 - 9.00am START PROMPT

IN HAND HUNTERS (P1-P4) VETERANS (P5-P6)
RACE TO RIDING HORSE (P7-P8) RIDDEN HUNTERS (P9-P14)
SIDE SADDLE (P15-P16)

IN-HAND OF HUNTER TYPE (Ring 1) P1-P4

Entry Fee: £5.00

Prizes for Classes P1-P4 1st: £8.00, 2nd: £6.00, 3rd: £4.00

Judge: Mr Vernon Beynon, Cross Farm, Clynderwen

- P1. Best Yearling, Colt, Gelding or Filly
- P2. Best 2 or 3 year old Colt, Gelding or Filly.
- P3. Barren Mare or Gelding, 4 years old or over.
- P4. In-Hand Sports Horse open to any yearling, 2 or 3 year old.

The Penryth Davies Perpetual Silver Cup for the Champion In-Hand Hunter (P1-P4)
Winners in Classes P1-P4 qualify - kindly donated by the late Mr Penryth Davies
(Mayor of St. Clears 1983/84)

Champion and Reserve Champion are eligible to compete
in Supreme Championship at 4.30pm

**Champion In-Hand Hunter 2016 – Cudlic Hugo A-Go-Go
Lucy Williams, Burton, Milford Haven**

VETERANS (Ring 1) P5-P6

Entry Fee: £5.00

Prizes for Classes P5-P6 1st: £8.00, 2nd: £6.00, 3rd: £4.00

Judge: Mr Vernon Beynon, Cross Farm, Clynderwen

- P5. **VETERAN IN HAND**, Horse/Pony to be Minimum of 15 years old, All Heights
Welcome, Handler of any age.
- P6. **VETERAN RIDDEN**, Horse/Pony to be Minimum of 15 years old, All Heights
Welcome, Rider of any age.

Championship Rosette for Veterans

1st & 2nd Prize Winners in Classes P5-P6 qualify

Champion and Reserve Champion are eligible to compete
in Supreme Championship at 4.30pm

Champion Veteran 2016 – Banjo: Gemma Rees, Wiston, Haverfordwest

RACE TO RIDING HORSE (Ring 1) P7 – P8

To be run under TARRA Rules and Show Ground Rules

Entry Fee: £5.00

Prizes for Classes P7 & P8 1st: £8.00, 2nd: £6.00, 3rd: £4.00

Judge: Mr Vernon Beynon, Cross Farm, Clynderwen

- P7. In Hand - Open to all Wetherby Registered Thoroughbreds, raced or not. Any age, Ideally racing name of horse. (Passports will be checked). Class will be judged as a normal In-Hand. Injuries caused through racing will be overlooked.
- P8. Ridden. Open to all Weatherby Registered Thoroughbreds, raced or not. Any age, Ideally racing name of horse. (Passports will be checked). Class will be judged as a Riding Horse without "type". Injuries caused through racing will be overlooked. Stallion Riders 16 years old and over. Judge will not ride, but may require an individual show.

Championship Silver Cup for the Champion Race to Riding Horse (P7 - P8)

1st & 2nd Prize winners in Classes P7 - P8 qualify

Champion and Reserve Champion are eligible to compete
in Supreme Championship at 4.30pm

**Champion Race to Riding Horse 2016 - Dhaka Dazzle
Abbie Dark, Crofty, Swansea**

RIDDEN HUNTERS (Ring 1) P9-P14

Entry Fee: £5.00

Prizes for Classes P9-P14 1st: £12.00, 2nd: £8.00, 3rd: £4.00

Judge: Mrs A W Burrington, Blagdon House,

Wheddon Cross, nr. Minehead, Somerset

Ridden Judge: To be confirmed

- P9. Novice Hunter Mare or Gelding, 4 year old and over - Combination not to have won a Ridden Hunter Class. Horse Exceeding 14.2hh (148cm) to be ridden by a Lady or Gent.
- P10. Best Small Ridden Hunter Mare or Gelding, 4 years old and over, Exceeding 14.2hh (148cm) and not Exceeding 15.2hh (158cm)
- P11. Lightweight / Middleweight Hunter - Mare or Gelding, four years old or over, to be ridden by a Lady or Gent.
- P12. Middleweight / Heavyweight Hunter - Mare or Gelding, four years old or over, to be ridden by a Lady or Gent
- P13. Open Riding Cob Mare or Gelding 4 years old or over Exceeding 148cms but not exceeding 155cms
- P14. Local Ridden Hunt Horse - to have been Hunted at least twice in 2016/17 season with a Hunt based within 50 mile radius of the showground.

The Davies-Evans Perpetual Silver Tray for the Champion Ridden Hunter (P9 - P14)

1st & 2nd Prize Winners in Classes P9 - P14 qualify - kindly donated by

Mrs Delme Davies-Evans (Past President) Pen-Y-Lan, Llangynog

Champion and Reserve Champion are eligible to compete
in Supreme Championship at 4.30pm

**Champion Ridden Hunter 2016 - Paxford Free Spirit
Malcolm Rosser, Llansamlet, Swansea**

SIDE SADDLE (Ring 1) P15-P16

Entry Fee: £5.00

Prizes for Classes P15-P16. 1st: £8.00, 2nd: £6.00, 3rd: £4.00
Run under SSA Rules

Judge:

Ridden Judge: To be confirmed

P15. **Side Saddle - Concours d' Elegance.** The sole criterion for this class is the elegance of the picture presented by horse/pony and rider and the way of going of the horse/pony. Judged on the overall elegance, picture and way of going. Competitors to Walk, Trot & Canter. No individual show, but groups of 3 or 4 riders may be asked to give a short display. Under 16s to wear Hard Hats. NO FANCY DRESS OR PERIOD DRESS

P16. **Equitation Open**

May be divided into an Adult and a Junior class at the discretion of the show.

Champion Silver Cup for the Side Saddle Champion (P15 - P16)

1st & 2nd Prize winners in Classes P15 - P16 qualify

Champion and Reserve Champion are eligible to compete
in Supreme Championship at 4.30pm

Champion Side Saddle 2016 - Touch of Diamond

Gemma Roberts, Glynogwr, Bridgend

RING 2 - 9.30am START PROMPT

LOCAL HORSE (P17-P18) IN HAND PONY BREEDING (P19-P21)

SHETLAND PONIES (P22-P27) COLOURED (P28-P31)

PURE WELSH RIDDEN (P32-P35)

LOCAL HORSE (Ring 2) P17-P18

Exhibitors must live within a 5 mile radius of St. Clears Post Office
and be the owners of the Animal.

Entry Fee: £5.00

Prizes for Classes P17-P18. 1st: £12.00, 2nd: £8.00, 3rd: £4.00

Judge: Mrs Emma Courtney-Roberts, 1 Pleasant Villas, Pontarddulais, Swansea

P17. **Novice Local** (Open to In Hand & Ridden)

To reside within a 5 mile radius of St. Clears Post Office. For Horses & Ponies that
have **NOT** won a 1st prize of £3.00 and over.

The Kimberley Perpetual Shield for the Novice (Local) (P17)
kindly donated by Mr & Mrs Steve Clack, Kimberley, St. Clears

Champion Novice Horse 2016 - Abaddon Seren

Mr B W D Llewelyn, Llanboidy, Whitland

- P18. **Open Local Horse or Pony.** (Open to In Hand & Ridden)
 To reside within a 5 mile radius of St. Clears Post Office.
 The Dr Edmond Davies Silver Perpetual Trophy for the Open (Local) (P18)
 kindly donated by Dr Edmond Davies (Mayor of St. Clears 1976/77)

**Champion Open Local Horse 2016 – Tabby
 Tasha Arber, Llangynog, Carmarthen**

Championship Rosette for the Champion Local
 1st & 2nd Prize Winners in Classes P17 & P18 qualify
 Champion and Reserve Champion are eligible to compete
 in Supreme Championship at 4.30pm

**Champion Local Horse 2016 – Tabby
 Tasha Arber, Llangynog, Carmarthen**

IN-HAND PONY BREEDING SECTION (Ring 2) P19-P21

Entry Fee: £5.00

Prizes for Classes P19-P21..... 1st: £8.00, 2nd: £6.00, 3rd: £4.00

Judge: Mrs Emma Courtney-Roberts, 1 Pleasant Villas, Pontarddulais, Swansea

- P19. Best Yearling of Show Pony OR Show Hunter Pony Type, In-Hand, Colt Filly or Gelding to make no more than 15hh (153cms)
 P20. Best 2 or 3 year old of Show Pony OR Show Hunter Pony Type, In-Hand, Colt, Filly or Gelding to make no more than 15hh (153cms)
 P21. Best Stallion, Barren Mare or Gelding.

The Wingrove Silver Perpetual Cup for Pony Breeding Champion
 1st & 2nd Prize Winners in Classes P19-P21 qualify –
 kindly donated by Jonathan & Sandra Williams, Cornel Ni, St. Clears
 Champion and Reserve Champion are eligible to compete
 in Supreme Championship at 4.30pm

**Champion In-Hand Pony 2016 – Small Land Equity
 Mrs Rosemary Rees, Small Land Stud, Meidrim, St. Clears**

SILVERWARE

Please return all Silverware won in 2016 by **1st April, 2017.**



Late or non-return of cups and shields will incorporate a **£250 fine**

SHETLAND PONY (Ring 2) P22-P27

Entry Fee: £5.00

Prizes for Classes P22-P27. 1st: £8.00, 2nd: £6.00, 3rd: £4.00

Judge: Mr Rosemary Rees, Lower Hasguard Farm, Haverfordwest

**QUALIFICATION CARDS MUST BE SIGNED BY THE JUDGEWHILST IN THE RING
THE SHETLAND PONY STUD BOOK SOCIETY**

www.shetlandponybooksociety.co.uk

These classes are confined to Registered Ponies. Ponies must be named and registration numbers shown on the entry form and in the Catalogue. Shetland Pony Society rosettes will only be given to ponies registered with the society or eligible for registration (i.e. Foals). Three year old fillies with foals at foot may not be shown. All foals must be a minimum of 3 weeks old on the day of the show. There are to be NO Colts or Entire Males in Young Handler Classes. Children under 14 years old may not show Colts, (excluding foals) or entire males in In-Hand classes. Children under 11 years old on the day of the show may not show entire males in ridden classes. In the interest of safety, hard hats must be worn by all handlers, aged 14 years or under in In-Hand classes and by all exhibitors, irrespective of age in ridden class.

- P22.* Shetland Mare or Gelding, In-hand
- P23.* Shetland Yearling - *Colt, Filly or Gelding*
- P24.* Shetland 2 or 3 year Old - *Filly or Gelding*
- P25. Shetland Stallion - *RULES APPLY*
- P26. Ridden Shetland - *RULES APPLY*
- P27. In-Hand Open Miniature Shetland, any age.

P22.*, P23.*, P24. The highest placed Geldings from these classes to compete for the Shetland Pony Society Rosette (Highest placed Gelding)

P22.*, P23.*, P24., P25., P26., P27. The highest placed Best Young Handler from these classes to compete for the Shetland Pony Society Rosette (Young Handler Rosette)

The Talacharn Pony Stud Silver Challenge Cup for Champion Shetland
1st & 2nd Prize Winners in Classes P22-P27 qualify

Champion and Reserve Champion are eligible to compete
in Supreme Championship at 4.30pm

kindly donated by the "Talacharn Pony Stud" Merry Moor, Laugharne

**Champion Shetland 2016 – Homer of Crofton
Mr & Mrs N True, Nantycaws, Carmarthen**

COLOURED HORSE (Ring 2) P28-P31

Classes P28-P31 are open to everyone and are not restricted
to CHAPS members or registered ponies.

Entry Fee: £5.00

Prizes for Classes P28-P31. 1st: £8.00, 2nd: £6.00, 3rd: £4.00

Judge: Rachel Morgans, 17 Cadwgan Road, Craig Cefn Parc, Clydach, Swansea

- P28. Native/Cob/Traditional **OPEN** In Hand - Any height
- P29. Non-Native **OPEN** In Hand - Any height.
- P30. **OPEN** Ridden **NATIVE/COB/TRADITIONAL**, 4 years old and over. Stallion, mare or gelding. Any height To be shown in their native state
- P31. **OPEN** Ridden **NON-NATIVE**, 4 years old and over. Stallion, mare or gelding. Any height to be shown plaited and trimmed.

The Bargain Box Perpetual Cup for the Champion Coloured Horse
1st & 2nd Prize Winners in classes P28-P31 qualify
kindly donated by Paul and Sue Marsden, Bargain Box, Narberth
Champion and Reserve Champion are eligible to compete
in Supreme Championship at 4.30pm

**Champion Coloured 2016 - New Halls Commander
Emily Evans, Steynton, Milford Haven**

PURE BRED WELSH PONY/COB RIDDEN (Ring 2) P32-P35

Entry Fee: £5.00

Prizes for Classes P32-P35..... 1st: £10.00, 2nd: £7.00, 3rd: £4.00

Judge: Rachel Morgans, 17 Cadwgan Road, Craig Cefn Parc, Clydach, Swansea
Judges will not ride the exhibits

P32. Ridden Welsh Section A - Stallion, Mare or Gelding four years old and over to be shown under saddle. **NO LEAD REIN ALLOWED** (Stallion Riders to be 12 years old and over) - to be ridden at all paces.

THE NATIONAL WELSH "BRYNSEION RIDDEN SECTION A" CHAMPIONSHIP.

The 2 highest placed ridden Welsh Section A ponies (P32) will qualify for this championship. If either pony has previously qualified, then it can be awarded to the next eligible pony.
Details from Secretary Mrs D L Partridge - 01633 482365

P33. Ridden Welsh Section B - Stallion, Mare or Gelding four years old and over to be shown under saddle **NO LEAD REIN ALLOWED** (Stallion Riders to be 12 years old and over) - to be ridden at all paces.

THE NATIONAL WELSH "BRYNSEION RIDDEN SECTION B" CHAMPIONSHIP.

The 2 highest placed ridden Welsh Section B ponies (P33) will qualify for this championship. If either pony has previously qualified, then it can be awarded to the next eligible pony.
Details from Secretary Mrs D L Partridge - 01633 482365

P34. Welsh Section C - Stallion, Mare or Gelding four years old and over to be shown under saddle.

THE NATIONAL WELSH "BRYNSEION RIDDEN SECTION C" CHAMPIONSHIP.

The 2 highest placed ridden Welsh Section C ponies (P34) will qualify for this Championship. If either pony has previously qualified, then it can be awarded to the next eligible pony.
Details from Secretary Mrs D L Partridge - 01633 482365

P35. Welsh Section D - Stallion, Mare or Gelding four years old and over to be shown under saddle.

THE NATIONAL WELSH "BRYNSEION RIDDEN SECTION D" CHAMPIONSHIP.

The 2 highest placed ridden Welsh Section D animals (P35) will qualify for this Championship. If either pony has previously qualified, then it can be awarded to the next eligible pony. Details from Secretary Mrs D L Partridge - 01633 482365

Champion and Reserve Champion are eligible to compete
in Supreme Championship at 4.30pm

The Glyngoch Stud Perpetual Trophy for the Champion Ridden Welsh Section
1st & 2nd Prize Winners in Classes P32-P35 qualify
kindly presented by Alan, Jan Pearce & Adrian Bowen.

**Champion Pure Bred Welsh Ridden 2016 - Trefriw Showman
Mr & Mrs J Brice, c/o Penuwch, Tregaron**

RING 3 - 10.00am START PROMPT

WELSH SECTION A (P36-P41)

WELSH SECTION B (P42-P47)

WELSH SECTION C (P48-P53)

WELSH SECTION D (P54-P59)

WELSH PONY & COB IN-HAND (Ring 3)

THE NATIONAL WELSH SARUM INVESTMENT LTD GELDING CHAMPIONSHIP.

IN EACH OF THE WELSH PONY & COB IN-HAND CLASSES, INCLUDING WELSH PART BRED, WHERE GELDINGS ARE ELIGIBLE TO COMPETE A QUALIFYING CARD WILL BE OFFERED TO THE HIGHEST PLACED GELDING IN EACH CLASS.

Please ensure that the following information is completed on entry form

*Animal's name and registration number

*Name of Sire and Dam (particularly in the case of foals)

*Name of recorded owner as it appears in the animal's passport at the time of the show (the name of the handler/producer is not sufficient on its own).

HEIGHT

All ponies, 4 years old and over come under the jurisdiction of the Joint Measurement Board.

The following heights apply

Section A	Welsh Mountain Ponies	Not Exceeding 121.9 cms	12.0 hands
Section B	Welsh Ponies	Not Exceeding 137.2 cms	13.2 hands
Section C	Welsh Ponies (Cob Type)	Not Exceeding 137.2 cms	13.2 hands
Section D	Welsh Cobs	Exceeding 13.2 hands	

STALLIONS AND COLTS

In the interest of safety all colts and stallions, two years old or over must be suitably bitted and led by a handler who has reached the age of 14 years or over before January 1st of the current year.

CLASSES IN SECTION A, B, C, D - ENTRIES CLOSE 10th MAY 2017 - SEE SCHEDULE RULE 22

WELSH PONY and COB SOCIETY (WPCS) MEDALS

St. Clears Show is affiliated to the Welsh Pony & Cob Society and is a Bronze Medal Show which will be awarded (members only) to the Champions or Reserve in Sections A, B, C & D respectively, according to the society's regulations. Ponies must be registered and exhibits catalogued to be eligible. This show will **NOW** be able to accept entries on the day at an additional cost of £2.50 per entry per class.

"Welsh Pony & Cob Society Incentive Scheme - Overall Gelding Champion and Reserve to be competed for by the highest placed gelding from each appropriate class within the Section A-B-C-D generously sponsored by the Millcroft Stud.

National High Point Junior Gelding of the Year open to all geldings three years of age and under shown In-Hand with points gained throughout the year. Free competition, cards are available for owners to complete from the Welsh Pony & Cob Society.

WELSH MOUNTAIN PONY – SECTION A (Ring 3) P36-P41

Affiliation & qualifying show details can be found on pages 8

Entry Fee: £5.00

Prizes for Classes P36, P38-P40 1st: £8.00, 2nd: £6.00, 3rd: £4.00
Class P37 No prize money – prize card and rosette only

**Judge: Mrs T Hook, Twyn-Yr-Hebog,
Station Road Gilwern, Gwent (KEMYSFAWR)**

- P36. *Section A* – Brood Mare, 4 years old and over, in foal or with foal at foot.
P37. *Section A* – Foal, progeny of mare in previous class 3 weeks or over on show day.
No Prize Money – Prize Cards and Rosette Only
P38.** *Section A* – Yearling – Colt, Filly or Gelding
P39.** *Section A* – 2 or 3 year old or over – Filly or Gelding
P40. *Section A* – Stallion 4yrs old and over.
P41.** *Section A* – Barren Mare or Gelding, 4yrs old and over.

The Rowland Michell Silver Challenge Cup for the Champion **SECTION A PONY**
1st & 2nd Prize Winners in Classes P36-P41 qualify –
kindly donated by Mr Rowland Michell M.R.C.V.S., St. Clears Show President 2012
To be won three times (not necessarily in succession)
before becoming the winner's property

**Champion Welsh Section A * Bronze Medal 2016 – Penboeth Emma
Miss D Morgan & Mr K Harries, North Cornelly, Bridgend**

****THE NATIONAL WELSH BRIGHTWELLS SECTION A IN HAND CHAMPIONSHIP.**

Both the Champion and Reserve Section A will qualify for the National Welsh Show,
Three Counties Showground, Malvern, 6th August, 2017.

In the event of either having previously qualified, then the qualification
will pass to the 2nd reserve in the championship.**

Details from Secretary Mrs D L Partridge – 01633 482365

*** "Welsh Pony & Cob Society Incentive Scheme – Overall Gelding Champion and Reserve to be competed for by the highest placed gelding from each appropriate class within the Section A-B-C-D generously sponsored by the Millcroft Stud.***
(Geldings P38, P39, P41 – Section A)***

ALL EXHIBITORS BRINGING ANY TYPE OF BEDDING ARE KINDLY ASKED
TO TAKE IT HOME WITH THEM AFTER THE SHOW

WELSH MOUNTAIN PONY – SECTION B (Ring 3) P42-P47

Entry Fee: £5.00

Prizes for Classes P42, P44-P47 1st: £8.00, 2nd: £6.00, 3rd: £4.00

Class P43 No prize money – prize card and rosette only

Judge: Mrs T Hook, Twyn-Yr-Hebog, Station Road Gilwern, Gwent (KEMYSFAWR)

P42. *Section B* – Brood Mare, 4 years old and over, in foal or with foal at foot.

P43. *Section B* – Foal, progeny of mare in previous class 3 weeks or over on show day.
No Prize Money – Prize Cards and Rosette Only

P44.** *Section B* – Yearling – Colt, Filly or Gelding

P45.** *Section B* – 2 or 3 year old and over – Filly or Gelding

P46. *Section B* – Stallion 4yrs old and over.

P47.** *Section B* – Barren Mare or Gelding, 4yrs old and over.

The Gelli Ganol Stud Perpetual Silver Rose Bowl for the Champion **SECTION B PONY**

1st & 2nd Prize Winners in Classes P42-P47 qualify –

kindly donated by Mr & Mrs Hooper, Gelli Ganol Pony Stud, Llanelli

Champion Welsh Section B – Waxwing Razzle Dazzle, Mrs P. Burnie

2016 Bronze Medal – Waxwing Razzle Dazzle, Mrs P. Burnie

****THE NATIONAL WELSH BRIGHTWELLS SECTION B IN HAND CHAMPIONSHIP.**

Both the Champion and Reserve Section B will qualify for the National Welsh Show,

Three Counties Showground, Malvern, 6th August, 2017.

In the event of either having previously qualified, then the qualification
will pass to the 2nd reserve in the championship.**

Details from Secretary Mrs D L Partridge – 01633 482365

Champion and Reserve Champion are eligible to compete
in Supreme Championship at 4.30pm

*** "Welsh Pony & Cob Society Incentive Scheme – Overall Gelding Champion and Reserve to be competed for by the highest placed gelding from each appropriate class within the Section A-B-C-D generously sponsored by the Millcroft Stud.*** (Geldings P44, P46, P47 – Section B)***

Champion Welsh Section B & Bronze Medal 2016 – Waxwing Razzle Dazzle

Mrs P. Burnie, c/o Myddfai, Llandovery

WELSH COB – SECTION C (Ring 3) P48-P53

Entry Fee: £5.00

Prizes for Classes P48, P50-P53 1st: £8.00, 2nd: £6.00, 3rd: £4.00

Class P49 No prize money – prize card and rosette only

Judge: Miss D J Everitt, Brynglas, Llangadog (DYRFAL)

P48. *Section C* – Brood Mare, 4 years old and over, or with foal at foot.

P49. *Section C* – Foal, progeny of mare in previous class 3 weeks or over on show day.
No Prize Money – Prize Cards and Rosette Only

P50.** *Section C* – Yearling – Colt, Filly or Gelding

P51.** *Section C* – 2 or 3 year old – Filly or Gelding

P52. *Section C* – Stallion 4yrs old and over.

P53.** *Section C* – Barren Mare or Gelding, 4yrs old and over.

The Chrislyn Stud Silver Perpetual Cup for the Champion Section C Cob
1st & 2nd Prize Winners in Classes P48 - P53 qualify
kindly donated by Mr Glyn Anthony, "The Chrislyn Stud", New House, Llangynnin
****THE NATIONAL WELSH BRIGHTWELLS SECTION C IN HAND CHAMPIONSHIP.**

Both the Champion and Reserve Section C will qualify for the National Welsh Show,
Three Counties Showground, Malvern, 6th August, 2017.

In the event of either having previously qualified, then the qualification
will pass to the 2nd reserve in the championship.**

Details from Secretary Mrs D L Partridge - 01633 482365

Champion and Reserve Champion are eligible to compete
in Supreme Championship at 4.30pm

*** "Welsh Pony & Cob Society Incentive Scheme - Overall Gelding Champion and
Reserve to be competed for by the highest placed gelding from each appropriate
class within the Section A-B-C-D generously sponsored by the Millcroft Stud.***
(Geldings P50, P51, P53 - Section C)***

**Champion Welsh Section C & 2016 Bronze Medal - Crossfield Danny Boy
D Dykes, c/o Cross Inn, Llanon**

WELSH COB - SECTION D (Ring 3) P54-P59

Entry Fee: £5.00

Prizes for Classes P54, P56-P59 1st: £8.00, 2nd: £6.00, 3rd: £4.00
Class P55 No prize money - prize card and rosette only

Judge: Miss D J Everitt, Brynglas, Llangadog (DYRFAL)

P54. *Section D - Brood Mare, 4 years old and over, with foal at foot.*

P55. *Section D - Foal, progeny of mare in previous class 3 weeks or over on show day.
No Prize Money Rosette Only*

P56.** *Section D - Yearling - Colt, Filly or Gelding*

P57.** *Section D - 2 or 3 year old - Filly or Gelding*

P58. *Section D - Stallion 4yrs old and over.*

P59.** *Section D - Barren Mare or Gelding, 4yrs old and over.*

****THE NATIONAL WELSH BRIGHTWELLS SECTION D IN HAND CHAMPIONSHIP.**

Both the Champion and Reserve Section D will qualify for the National Welsh Show,
Three Counties Showground, Malvern, 6th August, 2017.

In the event of either having previously qualified, then the qualification
will pass to the 2nd reserve in the championship.**

Details from Secretary Mrs D L Partridge - 01633 482365

Champion and Reserve Champion are eligible to compete
in Supreme Championship at 4.30pm

*** "Welsh Pony & Cob Society Incentive Scheme - Overall Gelding Champion and
Reserve to be competed for by the highest placed gelding from each appropriate
class within the Section A-B-C-D generously sponsored by the Millcroft Stud.***
(Geldings P56, P57, P59 - Section C)***

**Champion Welsh Section D & 2016 Bronze Medal - Fronaeth Royal Queen
Mr M Swinston, Llanmorlias, Gower**

**Overall Gelding from Section A, B, C, D to compete
for the Champion Gelding Championship**

Judge: Mrs Kath Hall, Bank Farm, Goodwick

RING 4 - 10.00am START PROMPT

BSPS SHOW PONY (P60-P61) BSPS OPEN SHOW PONY (P62-P64)
BSPS SHOW HUNTER PONY (P65-P66)
BSPS OPEN SHOW HUNTER PONY (P67-P71)
BSPS HERITAGE MOUNTAIN AND MOORLAND RIDDEN (P71-P73)

BSPS OPEN L/R AND F/R SHOW PONY (Ring 4) P60-P61

Classes P60-P73 are open to everyone and are not restricted to BSPS members or registered ponies.

Entry Fee: £5.00

Prizes for Classes P60-P61 1st: £10.00, 2nd: £7.00, 3rd: £4.00

**Judge: Ms Bryony Lovell-Williams, Ty Ffynnon Cottage,
Crickhowell Road, Gilwern, Abergavenny**

P60. BSPS Open Lead Rein Pony, Mare or Gelding 4 years old and over, not exceeding 122cms. Suitable to be ridden by a rider not to have attained their 8th birthday before 1st January in the current year. To be shown in snaffle bridles only. Rosettes for all competitors.

P61. BSPS Open First Ridden Pony, Mare or Gelding 4 years old and over, not exceeding 122cms. Suitable to be ridden by a rider not to have attained their 10th birthday before 1st January in the current year. Rosettes for all competitors.

The Talacharn Pony Stud Silver Perpetual Trophy for the Champion Child's Riding Pony
1st and 2nd Prize Winners in Classes P60 & P61 qualify
kindly donated by Talacharn Pony Stud, Laugharne

Champion and Reserve Champion are eligible to compete
in Supreme Championship at 4.30pm

The Champion will Qualify for the BSPS "Binks Family" Champion of Champions

**BSPS Open L/R F/R Champion 2016 – Cosford Perpelia
Jonathan Molloy, Solva, Haverfordwest**

BSPS OPEN SHOW PONY (Ring 4) P62-P64

Entry Fee: £5.00

Prizes for Classes P62- P64 1st: £10.00, 2nd: £7.00, 3rd: £4.00

**Judge: Ms Bryony Lovell-Williams, Ty Ffynnon Cottage,
Crickhowell Road, Gilwern, Abergavenny**

P62. BSPS Open Show Pony, Mare or Gelding, 4 years old or over, not exceeding 128cms. Suitable to be ridden by a riders not to have attained their 13th birthday before 1st January in the current year.

- P63. BSPS Open Show Pony, Mare or Gelding, 4 years old or over, exceeding 128cms but not exceeding 138cms. Suitable to be ridden by a riders not to have attained their 15th birthday before 1st January in the current year.
- P64. BSPS Open Show Pony, Mare or Gelding, 4 years old or over, exceeding 138cms, but not exceeding 148cms. Suitable to be ridden by a riders not to have attained their 17th birthday before 1st January in the current year.

The Lloyds Bank Challenge Cup for the Champion Show Pony
1st & 2nd Prize Winners in Classes P62-P64 qualify
Champion and Reserve Champion are eligible to compete
in Supreme Championship at 4.30pm

The Champion will Qualify for the BSPS "Binks Family" Champion of Champions

Open BSPS Champion 2016 – Cupidhill Caprice
Ann Pritchard Simmons, Whitchurch, Cardiff

BSPS SHOW HUNTER PONY (Ring 4) P65-P66

Entry Fee: £5.00

Prizes for Classes P65-P66. 1st: £10.00, 2nd: £7.00, 3rd: £4.00

**Judge: Ms Bryony Lovell-Williams, Ty Ffynnon Cottage,
Crickhowell Road, Gilwern, Abergavenny**

- P65. BSPS Open Lead Rein Pony of Hunter Type. Mare or Gelding 4 years old and over, not exceeding 122cms. Suitable to be ridden by a riders not to have attained their 9th Birthday before the 1st January in current year.
- P66. BSPS Open First Pony of Show Hunter Type. Mare or Gelding, 4 years old and over not exceeding 122cms. Suitable to be ridden by a riders not to have attained their 10th Birthday before the 1st January in current year. Snaffle Bridles Only.

The Equine Shop Perpetual Trophy for the Champion Mini Open Show Hunter Pony
1st & 2nd Prize Winners from Classes P65-P66 qualify -
kindly donated by Jane and Carol, The Equine Shop, Cross Hands
Champion and Reserve Champion are eligible to compete
in Supreme Championship at 4.30pm

Show Hunter Pony Champion 2016 – Witch Hill Wimsicall
Lucy Ann Hodds, Johnston, Haverfordwest

SILVERWARE

Please return all Silverware won in 2016 by **1st April, 2017.**



Late or non-return of cups and shields will incorporate a **£250 fine**

BSPS OPEN SHOW HUNTER PONY (Ring 4) P67-P71

Entry Fee: £5.00

Prizes for Classes P67-P61 1st: £10.00, 2nd: £7.00, 3rd: £4.00

**Judge: Ms Bryony Lovell-Williams, Ty Ffynnon Cottage,
Crickhowell Road, Gilwern, Abergavenny**

- P67. BSPS Open Pony of Show Hunter type. Mare or Gelding, 4 years old or over, not exceeding 122cms. Suitable to be ridden by a rider not to have attained their 12th birthday before 1st January in current year.
- P68. BSPS Open Pony of Show Hunter type. Mare or Gelding, 4 years old or over, exceeding 122cms and not exceeding 133cms. Suitable to be ridden by a rider not to have attained their 14th birthday before 1st January in current year.
- P69. BSPS Open Pony of Show Hunter Type. Mare or Gelding, 4 years old or over, exceeding 133cms and not exceeding 143cms. Suitable to be ridden by a rider not to have attained their 17th birthday before 1st January in current year.
- P70. BSPS Open Pony of Show Hunter Type. Mare or Gelding, 4 years old or over, exceeding 143cms and not exceeding 153cms. Suitable to be ridden by a rider not to have attained their 20th birthday before 1st January in current year.
- P71. BSPS Open Intermediate SH. Mare or Gelding 4 years old or over exceeding 148cms and not exceeding 158cms. Suitable to be ridden by a rider not to have attained their 25th birthday before 1st January in current year.

The Crane Family Silver Challenge Cup for the Champion Show Hunter Pony
Winners Only in classes P67 – P71 qualify -
kindly donated by Mr & Mrs David Crane, Penrheol, Meidrim
Champion and Reserve Champion are eligible to compete
in Supreme Championship at 4.30pm

The Champion will Qualify for the BSPS "Binks Family" Champion of Champions

**BSPS Open Show Hunter Champion 2016 – Dhaka Dazzle
Abbie Dark, Crofty, Swansea**

OVERALL SUPREME/HORSE PONY 2016

BSPS HERITAGE MOUNTAIN AND MOORLAND (Ring 4) P72-P73

Entry Fee: £5.00

Prizes for Classes P72-P73 1st: £8.00, 2nd: £6.00, 3rd: £4.00

Judge: Mrs R Rees, Small Land Stud, Meidrim, Carmarthen

- P72. Heritage Mountain and Moorland Open Leading Rein. Registered Pure Bred Mare or Gelding 4 years old or over not exceeding 122cms. Suitable to be ridden by a rider not to have attained their 9th Birthday before 1st January in the current year.

P73. Heritage Mountain and Moorland Open First Ridden Pony, Registered Pure Bred Mare or Gelding, 4 years old and over, not exceeding 128cms. Suitable to be ridden by a rider not to have attained their 12th birthday before 1st January in the current year.

The Prince's Gate Water Trophy for the Champion Mini Open Heritage Ridden M&M
1st & 2nd in Classes P72-P73 qualify

kindly donated by Messrs Glyn & David Jones, Princes Gate Water, Narberth

The two highest placed Welsh A and the two highest placed Welsh B in class P72 & P73 will qualify for the National Welsh Brynseion Stud Lead Rein and First Ridden Championships
Champion and Reserve Champion are eligible to compete
in Supreme Championship at 4.30pm

**Champion Ridden Heritage M & M 2016 – Gryngallt Pretty Picture
Aimee Hillard, Nantycaws, Carmarthen**

RING 5 - 9.00am START PROMPT

PALOMINO & DUNS (P74-P75)

IN HAND MOUNTAIN & MOORLAND (P76-P78)

RIDDEN MOUNTAIN AND MOORLAND (P79-P82) ARABS (P83-P86)

REGISTERED WELSH PART BRED IN HAND & RIDDEN (P87-P91)

UNAFFILIATED PALOMINOS, DUNS & CREMELLO (Ring 5) P74-P75

Entry Fee: £5.00

Prizes for Classes P74-P75..... 1st: £8.00, 2nd: £6.00, 3rd: £4.00

Judge: To be confirmed

P74. Palomino, Dun & Cremello Yearling, 2 & 3 year olds. IN-HAND

P75. Palomino, Dun & Cremello Open IN-HAND. Stallion, Mare or Gelding 4 years old and over.

Championship Rosette for the Champion Palomino

1st & 2nd Prize Winners in Classes P74-P75 qualify

The Grugeira Stud Challenge Cup kindly donated by Stan and Heather Strelley
Cremello Cup for the Champion Cremello In Classes P74-P75

Champion Cremello 2016 - No results

Champion and Reserve Champion are eligible to compete
in Supreme Championship at 4.30pm

**Champion Palomino, Dun, Cremello 2016 – Witchill Wimsikal
Sherril Bushen, Johnston, Haverfordwest**

ALL EXHIBITORS BRINGING ANY TYPE OF BEDDING ARE KINDLY ASKED
TO TAKE IT HOME WITH THEM AFTER THE SHOW

OPEN IN-HAND MOUNTAIN AND MOORLAND (Ring 5) P76-P78

Entry Fee: £5.00

Prizes for Classes P76-P78. 1st: £8.00, 2nd: £6.00, 3rd: £4.00

**Judge: Claire Parsons, Little Skirrid Farmhouse,
Coldbrook, Abergavenny**

- P76. Mountain and Moorland Youngstock ponies, 3 years and under
- P77. Mountain and Moorland Small Breeds, 4 years old and over. Small Breeds – Dartmoor, Exmoor, Shetland – Welsh Section A and Welsh Section B. (Part-Breds are not eligible)
- P78. Mountain and Moorland Large Breeds, 4 years old and over. Large Breeds – Dales, Fells, Highlands, New Forest, Connemara – Welsh Section C and Welsh Section D. (Part-Breds not eligible).

1st & 2nd Prize Winners in P76-P78 qualify for the Championship.
A Silver Cup donated by the Show Committee will be presented to the Champion.
Champion and Reserve Champion are eligible to compete
in Supreme Championship at 4.30pm

**Champion In-Hand Mountain & Moorland 2016 – Ceinewydd Fach Dewines
Mrs D. Russell & Family, New Quay, Ceredigion**

OPEN RIDDEN MOUNTAIN AND MOORLAND (Ring 5) P79-P82

Entry Fee: £5.00

Prizes for Classes P79-P82. 1st: £8.00, 2nd: £6.00, 3rd: £4.00

**Judge: Claire Parsons, Little Skirrid Farmhouse,
Coldbrook, Abergavenny**

- P79. Mountain and Moorland Lead Rein – Mares and geldings, four years old or over, not exceeding 12.hh (122cms). Open to registered pure bred M&M mare, geldings and stallions four years old and over. Riders must have attained their 3rd birthday, but must not have attained their 9th birthday before 1st January in the current year. (Part Breds are not eligible).
- P80. Mountain and Moorland First Ridden – Mares and geldings, four years old or over, not exceeding 12.2 hh (128cms). Open to registered pure bred M&M mares, geldings and stallions four years old and over. Riders must have attained their 3rd birthday, but must not have attained their 12th birthday before 1st January in the current year. (Part-Breds are not eligible)
- P81. Mountain and Moorland Open Ridden – Small Breeds Open to registered pure bred M&M mares, geldings and stallions four years old and over. Rider any age (except stallions). Stallion riders MUST be over 16 years old. Small Breeds – Dartmoor, Exmoor, Shetland – Welsh Section A and Welsh Section B. (Part-Breds are not eligible).

P82. Mountain and Moorland Open Ridden - Large Breeds Open to registered pure bred M&M mares, geldings and stallions four years old and over. Rider any age (except stallions). Stallion riders MUST be over 16 years old. Large Breeds - Dales, Fells, Highlands, New Forest, Connemara - Welsh Section C and Welsh Section D. (Part-Breds not eligible).

The Billy Rees Memorial Cup for the Champion Mountain and Moorland Pony
1st & 2nd Prize Winners in Classes P79-P82
qualify kindly donated by Mrs Val Rees, Cethin, Llangynin
Champion and Reserve Champion are eligible to compete
in Supreme Championship at 4.30pm

**Champion Open Ridden M & M 2016 – Ceinwydd Fach Dewines
Mrs D. Russell & Family, New Quay, Ceredigion**

ARABS (Ring 5) P83-P86

Entry Fee: £5.00

Prizes for Classes P83-P86. 1st: £8.00, 2nd: £6.00, 3rd: £4.00

Judge: Mrs Kath Hall, Bank Farm, Goodwick

- P83. Pure Bred Stallion, Mare or Gelding any age In-Hand.
- P84. Part Bred or Anglo Stallion, Mare or Gelding 4 years old and over In-Hand.
- P85. Part Bred or Anglo Gelding or Filly, yearling, 2 or 3 year old In-Hand.
- P86. Ridden Pure or Part Bred or Anglo Stallion, Mare or Gelding, 4 years old and over. Stallion Riders to be 14 years or over.

The Hancock Family's Silver Perpetual Cup for the Champion Arab
1st & 2nd Prize Winners in Classes P83-P86 qualify
kindly donated by the late Mr G. Hancock & Mrs Hancock, Pwlllygravel, St. Clears
Champion and Reserve Champion are eligible to compete
in Supreme Championship at 4.30pm

**Champion Arab 2016 – Design With Class
Mr & Mrs Hackley, Laugharne, St. Clears**

SILVERWARE

Please return all Silverware won in 2016 by **1st April, 2017.**



Late or non-return of cups and shields will incorporate a **£250 fine**

REGISTERED PART BRED WELSH IN-HAND & REGISTERED PART BRED RIDDEN (Ring 5) P87-P91

Entry Fee: £5.00

Prizes for Classes P87-P91 1st: £8.00, 2nd: £6.00, 3rd: £4.00

Judge: Mrs Kath Hall, Bank Farm, Goodwick

- P87. Welsh Part Bred - Yearling - Colt, Filly or Gelding
- P88. Welsh Part Bred - 2 or 3 year old - Filly or Gelding
- P89. Welsh Part Bred - Barren Mare or Gelding, 4 years old and over

THESE ARE NEW CLASSES FOR 2017

- P90. ****Ridden Welsh Part Bred** - Small Breeds not exceeding 148cms, Mare or Gelding four years old or over. Riders of stallions must have attained their 12th birthday before 01.01.2017
- P91. ****Ridden Welsh Part Bred** - Large Breeds, Mare or Gelding four years old or over exceeding 148 cms. Riders of stallions must have attained their 14th birthday before 01.01.2017

The "Exton Sophora" Perpetual Shield for the Champion Welsh Part Bred
1st & 2nd Prize Winner Classes P87-P91 to qualify –
kindly donated by Mr David Peckham, (formerly) Bryn Hyfryd, Llanddowror.

Champion and Reserve Champion are eligible to compete
in Supreme Championship at 4.30pm

****THE NATIONAL WELSH BRIGHTWELLS WPBR IN HAND CHAMPIONSHIP.**

Both the Champion and Reserve will qualify for the National Welsh Show,
Three Counties Showground, Malvern, 6th August, 2017.

In the event of either having previously qualified, then the qualification
will pass to the 2nd reserve in the championship.

Details from Secretary Mrs D L Partridge - 01633 482365

The National Welsh Sarum Investment Ltd Gelding Championship.
In each of the Welsh Pony & Cob In-Hand Classes, including Welsh Part Bred,
where geldings are eligible to compete a qualifying card will be offered
to the highest placed gelding in each class.

**Champion and Reserve will qualify for the National Welsh Brightwells
Part Bred In-Hand Championship 6th August 2017**

**Champion Registered Part Bred 2016 – Small Land Equity
Mrs R Rees, Small Land Stud, Meidrim, St. Clears**

ALL EXHIBITORS BRINGING ANY TYPE OF BEDDING ARE KINDLY ASKED
TO TAKE IT HOME WITH THEM AFTER THE SHOW

RING 6 - 8.30am START PROMPT

BSPS OPEN CRADLE STAKES - PONY NOT EXCEEDING 122cms (P92)

BSPS OPEN NURSERY - PONY NOT EXCEEDING 133cms (P93)

BSPS NOVICE NOT EXCEEDING 133cms (P94)

BSPS NOVICE NOT EXCEEDING 143cms (P95)

BSPS NOVICE NOT EXCEEDING 153cms (P96)

BSPS NOVICE NOT EXCEEDING 158cms (P97)

BSPS OPEN WORKING HUNTER - NOT EXCEEDING 133cms (P98)

BSPS OPEN WORKING HUNTER - NOT EXCEEDING 143cms (P99)

BSPS OPEN WORKING HUNTER - NOT EXCEEDING 153cms (P100)

BSPS OPEN WORKING HUNTER - NOT EXCEEDING 158cms (P101)

BSPS HERITAGE OPEN MOUNTAIN AND MOORLAND -
NOT EXCEEDING 122cms (P102)

BSPS HERITAGE OPEN MOUNTAIN AND MOORLAND -
NOT EXCEEDING 133cms (P103)

BSPS HERITAGE OPEN MOUNTAIN AND MOORLAND -
NOT EXCEEDING 143cms (P104)

BSPS HERITAGE OPEN MOUNTAIN AND MOORLAND -
EXCEEDING 143cms (P105)

NOVICE WORKING HUNTER HORSE EXCEEDING 15 H.H. -
NOT TO HAVE WON A FIRST PRIZE IN A WH CLASS. (P106)

OPEN WORKING HUNTER HORSE EXCEEDING 15 H.H (P107)

**CLASSES P92-P105 ARE OPEN TO EVERYONE & ARE NOT RESTRICTED
TO BSPS MEMBERS OR REGISTERED PONIES**

Entry Fee: £5.00

Prizes for Classes P92-P107..... 1st: £10.00, 2nd: £7.00, 3rd: £4.00

**Judges: Mrs D L Partridge, Rosedale Stud, Gelli Fawr Farm,
Henllys, Cwmbran. (ROSEDALE)
Mr Anthony Williams, Skerryback, St. Ishmaels, Haverfordwest
BSPS Course Builder: Mr Stephen Craddock,
Holly Bush Farm, Spalling Down, Cowbridge**

MARKING

PHASE ONE

Jumping.....	50
Style & Manners while Jumping	20

PHASE TWO

Manners and way of going	10
Conformation, Type and Freedom of Action	20
TOTAL.....	100

PENALTIES - PHASE ONE

Jumping Knock Down	10
First Refusal	15
Second Refusal	20
Third Refusal	Disqualification
Fall of pony or rider in any phase	Disqualification

WORKING HUNTER PONY (Ring 6) P92-P93

- P92. BSPS Open Cradle Stakes, Mare or Gelding, 4 years old or over, not exceeding 122cms. Rider not to have attained their 11th birthday before 1st January in the current year. Maximum height of Jumps 70cms. Special Rosettes for all places.
- P93. BSPS Open Nursery Stakes, Mare or Gelding, 4 years old or over, not exceeding 133cms. Rider not to have attained their 12th birthday before 1st January in the current year. Maximum height of Jumps 75cms. Special Rosettes for all places.

The Clack Family Silver Challenge Tray for Mini Champion Working Hunter Pony
1st & 2nd prize winners in Classes P92 & P93 qualify

kindly donated by Mr & Mrs Steven Clack, Kimberley, Salem Road, St. Clears

The Champion will qualify for the BSPS "Binks Family" Champion of Champions

Champion and Reserve Champion are eligible to compete
in Supreme Championship at 4.30pm

Champion Mini Working Hunter 2016 – Cashael Mai

Adrian Brunt, Llangunnor, Carmarthen

NOVICE WORKING HUNTER PONY (Ring 6) P94-P97

- P94. BSPS Novice WHP Mare or Gelding, 4 years old and over, not exceeding 133cms. Rider not to have attained their 14th Birthday before 1st January current year. Maximum height of Jumps 75cms.
- P95. BSPS Novice WHP Mare or Gelding, 4 years and over exceeding 133cms and not exceeding 143cms. Rider not to have attained their 17th birthday before 1st January in the current year. Maximum height of Jumps 85cms.
- P96. BSPS Novice WHP Mare or Gelding, 4 years old and over, exceeding 143cms and not exceeding 153cms. Rider not to have attained their 20th birthday before 1st January in the current year. Maximum height of Jumps 90cms.
- P97. BSPS Novice Intermediate WHP Mare or Gelding exceeding 148cms and not exceeding 158cms. Riders not to have attained their 25th birthday before 1st January in the current year. Maximum height of Jumps 1 metre.

A Silver Challenge Cup for the Novice Champion Working Hunter Pony.

1st & 2nd prize winners in Classes P94 - P97 qualify
kindly donated by Carmarthen Farmers, St. Clears.

Champion and Reserve Champion are eligible to compete
in Supreme Championship at 4.30pm

Champion Novice WHP 2016 – Ashway Franco

Rob Yate, Pembrey, Burry Port

OPEN WORKING HUNTER PONY (Ring 6) P98-P101

- P98. BSPS Open WHP Mare or Gelding, 4 years old and over, not exceeding 133cms. Rider not to have attained their 14th Birthday before 1st January current year. Maximum height of Jumps 90cms.
- P99. BSPS Open WHP Mare or Gelding, 4 years old and over exceeding 133cms and not exceeding 143cms. Rider not to have attained their 17th birthday before 1st January in the current year. Maximum height of Jumps 1m 00cms
- P100. BSPS Open WHP Mare or Gelding, 4 years old and over, exceeding 143cms and not exceeding 153cms. Rider not to have attained their 20th birthday before 1st January in the current year. Maximum height of Jumps 1m 05cms.
- P101. BSPS Open Intermediate WHP Mare or Gelding exceeding 148cms and not exceeding 158cms. Riders not to have attained their 25th birthday before 1st January in the current year. Maximum height of Jumps 1m 15cms.

The Horse Secretary's Silver Salver for the Champion Open Working Hunter

1st & 2nd Prize Winners from Classes P98 - P101 qualify
kindly donated by Mrs Paula Coles, (formerly) Bryn Hyfryd, Llanddowror
(Past Horse Section Secretary)

Champion and Reserve Champion are eligible to compete
in Supreme Championship at 4.30pm

The Champion will Qualify for the BSPS "Binks Family" Champion of Champions

Champion Open WHP 2016 – Ray

Lauren Jones, Garth, Maesteg

HERITAGE OPEN WORKING WHP CLASSES (Ring 6) P102-P105

Please see B.S.P.S Rule 365 in the B.S.P.S. Rule and Show Handbook
as these classes are now split into 4 classes

**Judge: Mrs Sharon Thomas, The Long Barn,
Longden Wood Farm, Shewsbury, Shropshire**

- P102. BSPS Heritage Open Mountain and Moorland Open Working Hunter Pony. Registered Pure Bred Ponies 4 years old or over NOT exceeding 122cms. Riders any age.
- P103. BSPS Heritage Open Mountain and Moorland Working Hunter Pony. Registered Pure Bred Ponies 4 years old and over exceeding 122cms and NOT exceeding 133cms. Riders any age.
- P104. BSPS Heritage Open Mountain and Moorland Working Hunter Pony. Registered Pure Bred Ponies 4 years old or over exceeding 133cms but not exceeding 143cms. Riders any age.
- P105. BSPS Heritage Open Mountain and Moorland Working Hunter Pony. Registered Pure Bred Ponies 4 years old and over exceeding 143cms. Riders any age.

The Mallard's Reach Perpetual Cup for the Champion Open Heritage M & M W.H.P
1st & 2nd Prize Winners from Classes P102-P105 qualify

kindly donated by The James Family of Mallard's Reach Training Centre, Camrose

Champion and Reserve Champion are eligible to compete
in Supreme Championship at 4.30pm

**Champion Heritage M & M 2016 – Ervelough Padraic
Amy Tough, Mallards Reach Equestrian, Haverfordwest**

WORKING HUNTER HORSE SECTION (Ring 6) P106-107

- P106. Novice Working Hunter Horse, exceeding 15hh, never to have won any previous 1st prize in a Working Hunter Class.
- P107. Open Working Hunter exceeding 15hh

The G. W. Williams & Sons Perpetual Cup for the Champion W.H.

1st & 2nd Prize Winners from Classes P106 - P107 qualify
kindly donated by Mr G. W. Williams, Show President 2010

Champion and Reserve Champion are eligible to compete
in Supreme Championship at 4.30pm

**Champion Working Hunter Horse 2016 – Veronica Valette
Helen Tegg, Stepaside, Narberth**

**SUPREME CHAMPION HORSE
GRANDSTAND 4.30pm approx**

2017 - All Silverware will be presented after the judging of the Supreme Champion Horse and not before. Those who do not wish to take part must inform the Horse Section Secretary and will therefore forfeit the right to any Trophies won.

**THE EQUITY & LAW PERPETUAL SILVER TROPHY
FOR THE SUPREME CHAMPION HORSE/PONY**



OVERALL SUPREME HORSE/PONY 2016

Dhaka Dazzle
Abbie Dark, Crofty, Swansea
BSPS Open Show Hunter Champion 2016
Race to Riding Horse 2016



SUPREME HORSE JUDGE 2017

Mr Christopher Jones, "LLANRI STUD", 2 Maes Y Coleg, Llandoverly

ST CLEARS YFC AGRICULTURAL SHOW 2017 MAP

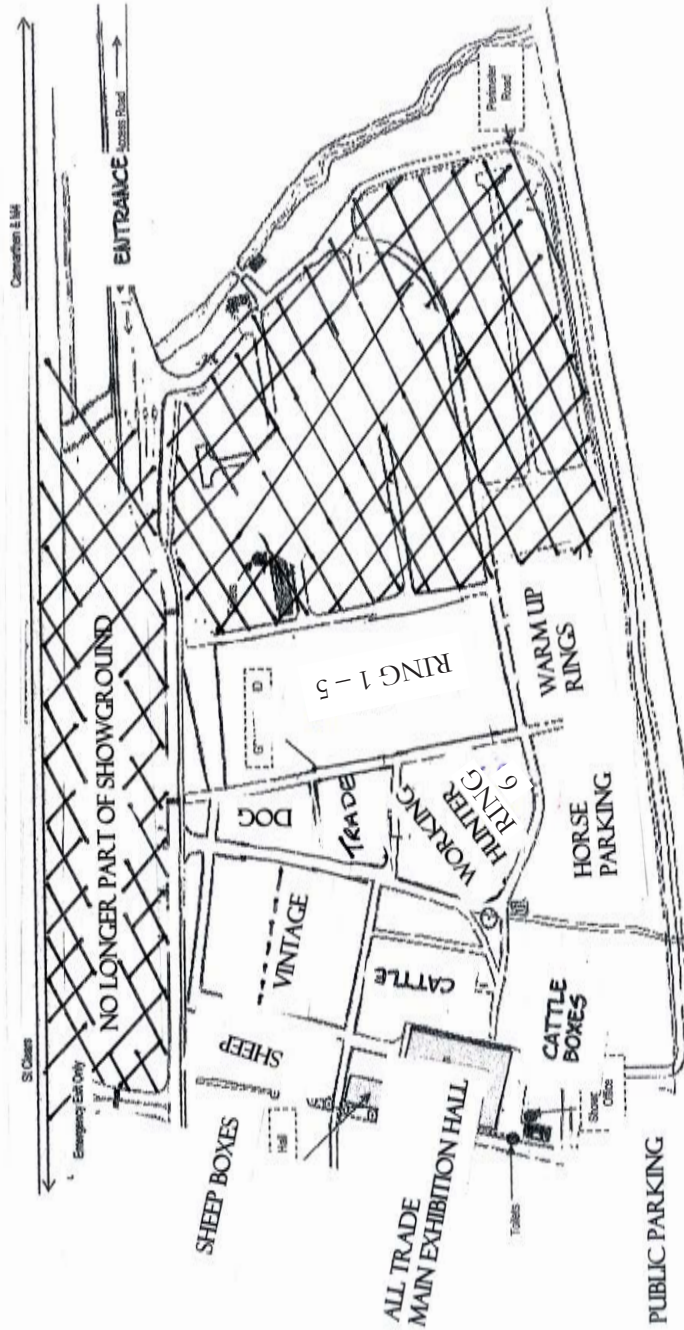

THE SHOWGROUND, CARMARTHEN

ALL ENQUIRIES - ALISON EBSWORTH
GENERAL SECRETARY 2017 TEL- 07870 390734